

Campagnolo®

SPARE PARTS
and TOOLS
catalogue

2008

SERIE STERZO • HEADSET • STEUERSATZ • JEU DE DIRECTION

Record™ - Record™ Threadless™ 1" - 1-1/8"	1
Record™ Hiddenset™ 1-1/8" - 1-1/8" TTC™	2
Chorus™ Threadless™	1
Chorus™ Hiddenset™ 1-1/8" - 1-1/8" TTC™ - Centaur™ Hiddenset™ 1-1/8"	3

REGGISSELLA • SEAT POST • SATTELSTÜTZE • TIGE DE SELLE

Record™ Carbon - Chorus™ Carbon - Centaur™	4
--	---

MOVIMENTO CENTRALE • BOTTOM BRACKET • INNENLAGER • JEU DE PEDALIER

Record™ Pista™	5
Centaur™	6
Veloce™	7

GUARNITURA • CRANKSET • KETTENRADGARNITUR • PEDALIER

Record™ ULTRA-TORQUE™ Carbon 10s	8
Record™ ULTRA-TORQUE™ CT™ Carbon 10s	9
Record™ Pista™	10
Chorus™ ULTRA-TORQUE™ Carbon 10s	11
Chorus™ ULTRA-TORQUE™ CT™ Carbon 10s	12
Centaur™ ULTRA-TORQUE™ Carbon 10s	13
Centaur™ ULTRA-TORQUE™ CT™ Carbon 10s	14
Centaur™ ULTRA-TORQUE™ 10s	15
Centaur™ ULTRA-TORQUE™ CT™ 10s	16
Veloce™ ULTRA-TORQUE™ 10s - Veloce™ INFINITE™ ULTRA-TORQUE™ 10s	17
Veloce™ ULTRA-TORQUE™ CT™ 10s - Veloce™ INFINITE™ ULTRA-TORQUE™ CT™ 10s	18
Mirage™ ULTRA-TORQUE™ 10s	19
Mirage™ ULTRA-TORQUE™ CT™ 10s	20
Xenon™ CT™ 10s	21
Comp Triple™ 10s	22
Race Triple™ 10s	23
Champ Triple™ 9s	24
Time Trial™ chainrings	25

CAMBIO • REAR DERAILLEUR • SCHALTUNG • DERAILLEUR ARRIERE

Record™ 10s	26
Chorus™ 10s	27
Centaur™ 10s	28
Veloce™ 10s - Veloce™ INFINITE™ 10s	29
Mirage™ 10s	30
Xenon™ 10s	31
Comp Triple™ 10s	32
Race Triple™ 10s	33
Champ Triple™ 9s	34

DERAGLIATORE • FRONT DERAILLEUR • UMWERFER • DERAILLEUR AVANT

Record™ QS™ 10s	35
Chorus™ QS™ 10s	36
Centaur™ QS™ 10s	37
Veloce™ QS™ 10s - Veloce™ QS™ INFINITE™ 10s	38
Mirage™ QS™ 10s	39
Xenon™ QS™ CT™ 10s	40
Comp Triple™ 10s	41
Race Triple™ 10s	42
Champ Triple™ 9s	43

ERGOPOWER™ CONTROL LEVERS

Record™ QS™ 10s	44
Chorus™ QS™ 10s	45
Centaur™ QS™ ESCAPE™ 10s	46
Veloce™ QS™ ESCAPE™ 10s	47
Mirage™ QS™ ESCAPE™ 10s	48
Xenon™ QS™ ESCAPE™ 10s	49
Ergopower™ control levers / rear derailleurs cross compatibility	50

ERGOPOWER™ FLAT-BAR CONTROL LEVERS

Chorus™ FB 10s	53
Veloce™ FB 10s	54
Veloce™ FB 10s for Linear Pull Cantilever brakes	55
Mirage™ FB 10s	56
Mirage™ FB 10s for Linear Pull Cantilever brakes	57

FRENI • BRAKES • BREMSSEN • FREINS

Record-D™ SKELETON™	58
Chorus-D™ SKELETON™	59
Centaur-D™ SKELETON™	60
Centaur™	61
Veloce-D™ SKELETON™ - Veloce-D™ INFINITE™ SKELETON™	62
Veloce™	63
Veloce™ Linear Pull Cantilever	64
Mirage™ Black	65
Mirage™ Black Linear Pull Cantilever	66

BAR-END

Time Trial™ Bar-End	67
---------------------------	----

COMANDI FRENO • BRAKE LEVERS • BREMSHEBEL • POIGNEES DE FREINS

Record™ Carbon	68
----------------------	----

BLOCCAGGI • QUICK RELEASES • SCHNELLSPANNER • BLOCAGES

Complete quick-releases and spares	69
--	----

MOZZI • HUBS • NABEN • MOYEUX

Record™ front hub	70
Record™ rear hub	71
Centaur™ / Veloce™ front and rear hub	72
Mirage™ front and rear hub	73
Record™ Pista™ front hub	74
Record™ Pista™ rear hub	75

GHIERE • LOCKRINGS • VERSCHLUSSRING • ECROUS

Complete range	76
----------------------	----

PIGNONI • SPROCKETS • RITZEL • CASSETTES

Record™ UD™ 10s	77
Record™ UD™ 10s Titanium	78
Chorus™ UD™ 10s	79
Centaur™ UD™ 10s	80
Veloce™ UD™ 10s	81
Veloce™ UD™ 9s (Mirage™ compatible)	82

PEDALI • PEDALS • PEDALE • PEDALES

Record™ Pro-Fit PLUS™	83
Chorus™ Pro-Fit PLUS™	83
Other spares	84

CAVI E GUAINA • CABLES AND CASINGS • KABEL UND HÜLLEN • CABLES ET GAINES

Complete sets	86
Single parts	87

ERGOBRAIN™

Parts	88
-------------	----

VARI • VARIOUS • VERSCHIEDENES • DIVERSES

Ergopower™ control levers blocks / 8s adapter kit for 9/10s / HD-Link™ / Wheel bag	89
Original spare parts	90

RUOTE • WHEELS • LAUFRÄDER • ROUES

LOW-PROFILE WHEEL - Hyperon™ Ultra™ clincher	92
LOW-PROFILE WHEEL - Hyperon™ Ultra™ tubular	93
LOW-PROFILE WHEEL - Neutron™ clincher	94
LOW-PROFILE WHEEL - Neutron™ Ultra™ clincher	95
MEDIUM-PROFILE WHEEL - Shamal™ Ultra™ clincher	96
MEDIUM-PROFILE WHEEL - Shamal™ Ultra™ tubular	97
MEDIUM-PROFILE WHEEL - Eurus™ clincher	98
MEDIUM-PROFILE WHEEL - Eurus™ tubular	99
MEDIUM-PROFILE WHEEL - Zonda™ clincher	100
MEDIUM-PROFILE WHEEL - Scirocco™ clincher	101
MEDIUM-PROFILE WHEEL - Vento™ clincher	102
MEDIUM-PROFILE WHEEL - Khamsin™ clincher	103
HIGH-PROFILE WHEEL - Bora™ Ultra™ tubular	104
HIGH-PROFILE WHEEL - Pista™ tubular	105
Bora™ Ultra™ / Hyperon™ Ultra™ tubular / Hyperon™ Ultra™ clincher front hub	106
Bora™ Ultra™ / Hyperon™ Ultra™ tubular / Hyperon™ Ultra™ clincher rear hub	107
Eurus™ / Zonda™ / Shamal™ Ultra™ front hub	108
Eurus™ / Zonda™ / Shamal™ Ultra™ rear hub	109
Neutron™ / Neutron™ Ultra™ front hub	110
Neutron™ / Neutron™ Ultra™ rear hub	111
Ghibli™ Road rear	112
Ghibli™ Track front and rear	113
Scirocco™ front and rear hub	114
Vento™ / Khamsin™ front and rear hub	115
Pista™ front hub	116
Pista™ rear hub	117

UTENSILI • TOOLS • WERKZEUGE • OUTILS

Recommended tools	118
Headset	119
Bottom bracket	124
Frame preparation	128
Cranks / chainrings	130
Hubs & wheels	132
Sprockets / chains	135

CAVATAPPI • CORKSCREWS • KORKENZIEHER • TIRE-BOUCHONS

BIG™	136
MIRO™	137

Glossary	138
Service Centers	139

RECORD™
HS7-RE

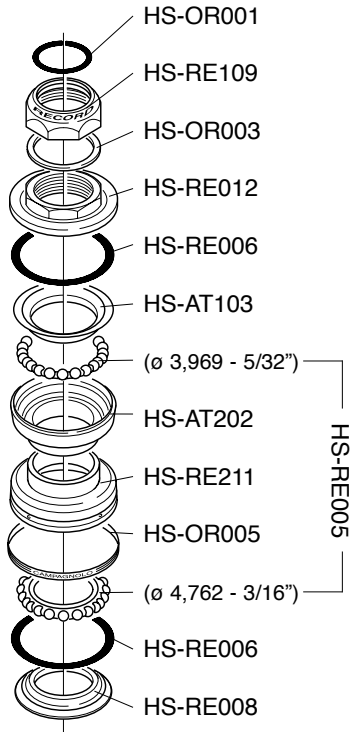

RECORD™ Threadless™
1": HS00-RETH
1 1/8": HS00-RETHOS

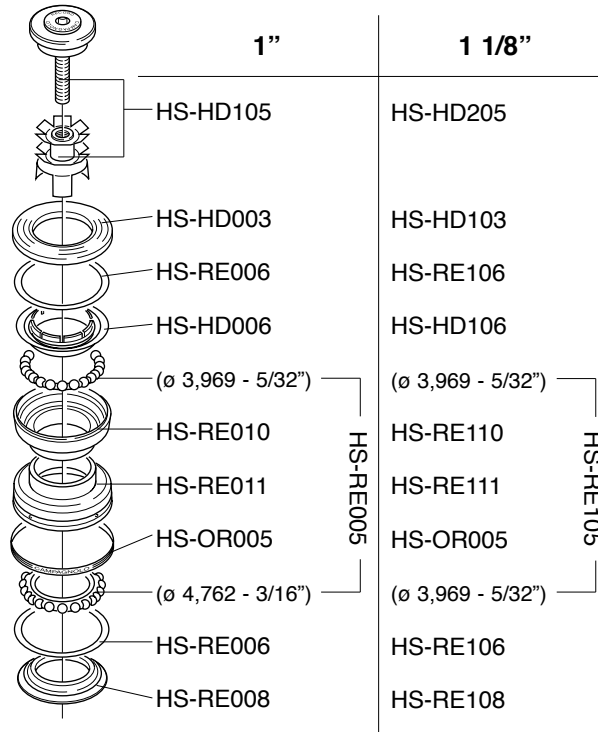

CHORUS™
Threadless™
HS00-CHTH

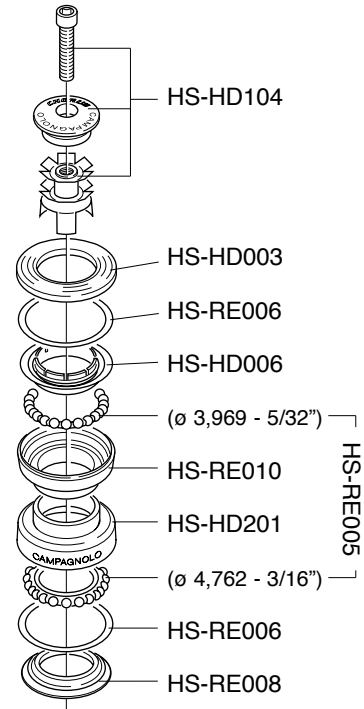

RECORD™
Hiddenset™
1 1/8": HS03-REHIOS

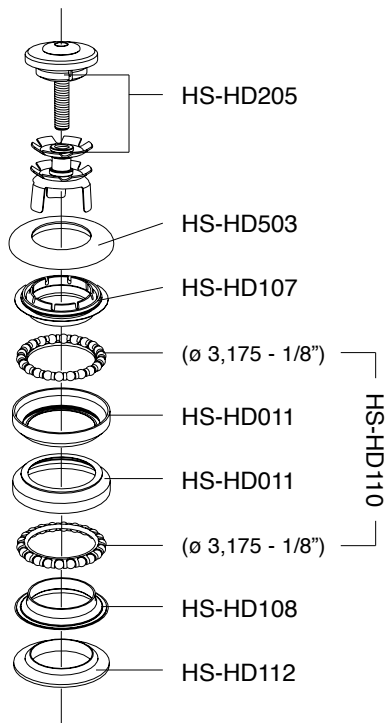

RECORD™
Hiddenset™ TTC™
1 1/8": HS03-REHIOST

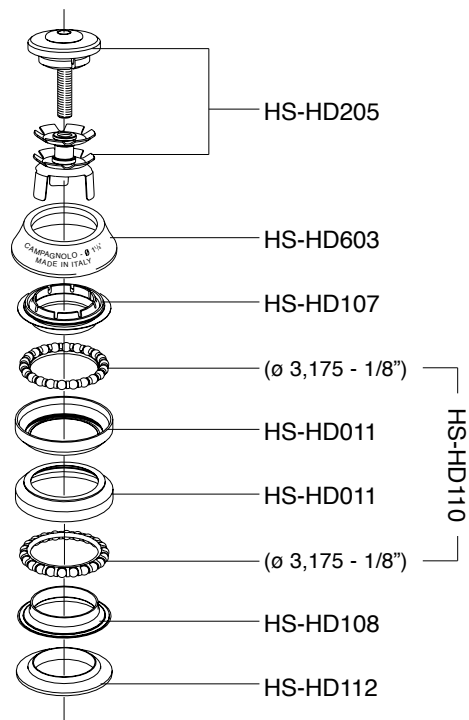

CHORUS™ Hiddenset™

1 1/8": HS03-CHHIOS

CENTAUR™ Hiddenset™

1 1/8": HS4-CEH8

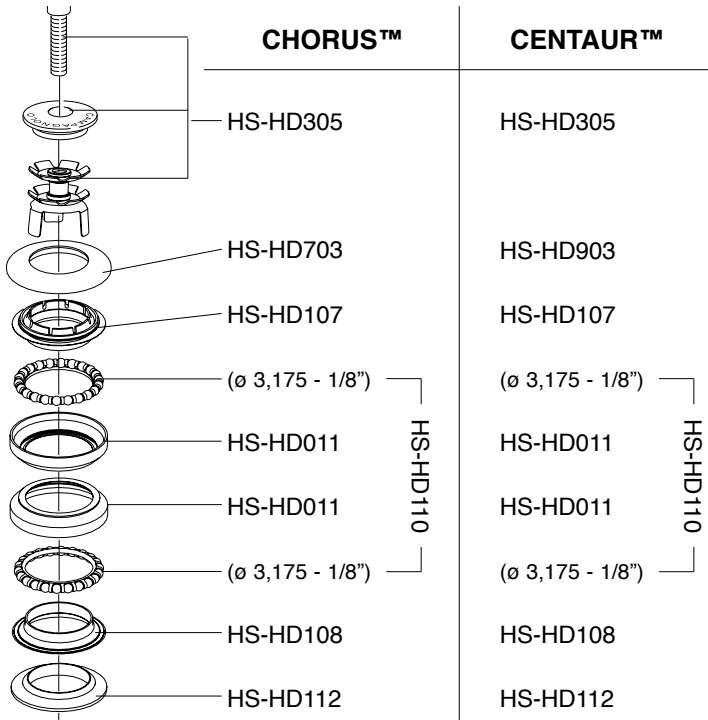

CHORUS™ Hiddenset™

TTC™

1 1/8": HS03-CHHIOS

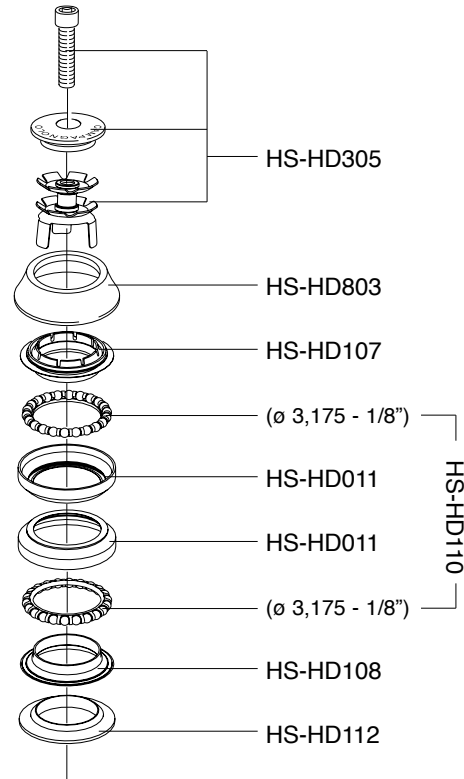

RECORD™
Carbon
SP4-RE27C
SP4-RE31CL
SP4-RE32CL

CHORUS™
Carbon
SP4-CH27C
SP4-CH31CL
SP4-CH32CL

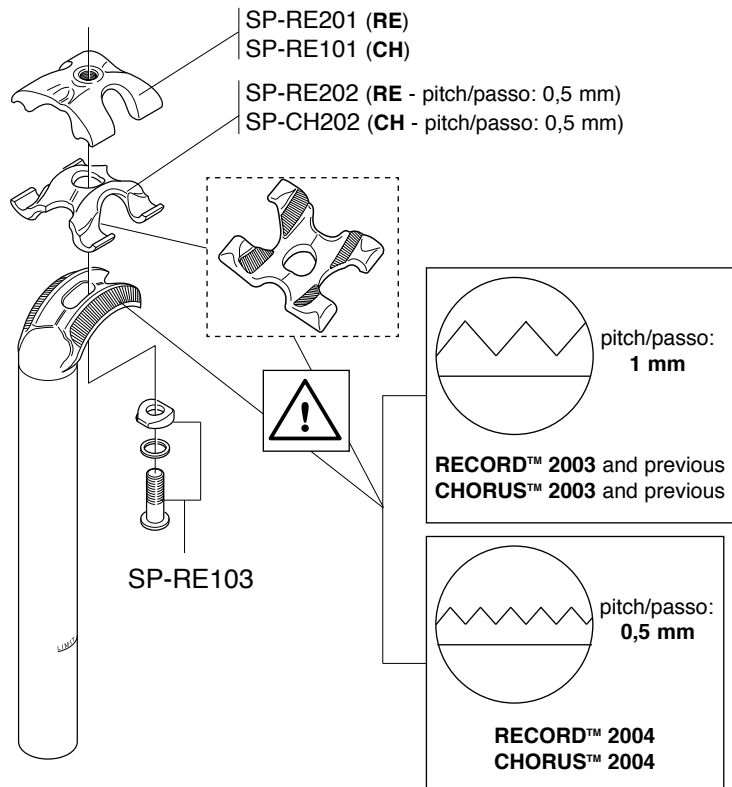

5-SP-RE104 (5 pcs.)
50-SP-RE104 (50 pcs.)

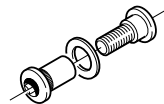

SP-RE106 (1 pc.)
5-SP-RE106 (5 pcs.)
 per tubi Ø 31,6 / 31,9 mm
 for tubes Ø 31,6 / 31,9 mm

SP-RE108 (1 pc.)
5-SP-RE108 (5 pcs.)
 per tubi Ø 34,9 / 35,2 mm
 for tubes Ø 34,9 / 35,2 mm

SP-RE107 (1 pc.)
5-SP-RE107 (5 pcs.)
 per tubi Ø 35,5 / 35,8 mm
 for tubes Ø 35,5 / 35,8 mm

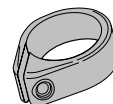

WARNING!

With the 2004 product range the pitch of all the heads (5 - Fig. 1) on the RECORD™ and CHORUS™ seat post tubes and the relevant seat clamps (1 - Fig. 1) has been reduced from 1 mm to 0.5 mm. A seat clamp (1 - Fig. 1) with 0.5 mm pitch is not compatible with heads (5 - Fig. 1) with a 1-mm pitch and vice versa. NEVER use seat clamps and heads that are not compatible with one another; the seat clamp could slip causing you to lose control of your bicycle, resulting in an accident, personal injury or death.

ATTENZIONE!

A partire dalla gamma 2004 è stato dimezzato il passo (da 1 mm a 0,5 mm) di tutte le teste (5 - Fig. 1) e delle relative staffe inferiori (1 - Fig. 1) dei reggisella RECORD™ e CHORUS™. Una staffa (1 - Fig. 1) con passo da 0,5 mm non è compatibile con le teste (5 - Fig. 1) con passo da 1 mm e viceversa. Non utilizzate MAI staffe e teste non compatibili tra loro; la staffa potrebbe slittare e potreste incorrere in incidenti, lesioni fisiche o morte.

RECORD™ PISTA™

111 mm

BB01-REPIIT

BB01-REPIBC

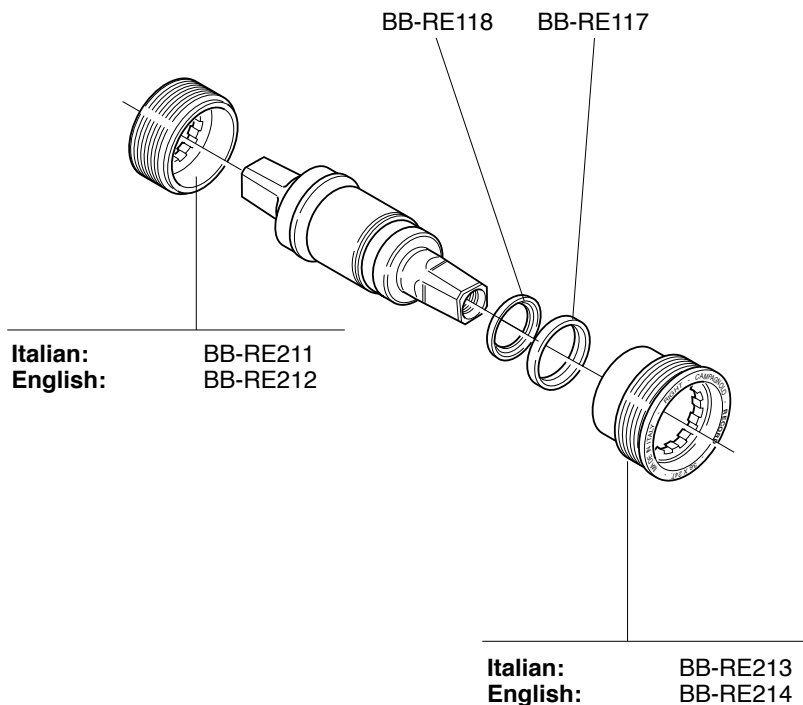

CENTAUR™
111 mm
BB5-CE1I
BB5-CE1G

115,5 mm
BB6-CE5I
BB6-VE5G

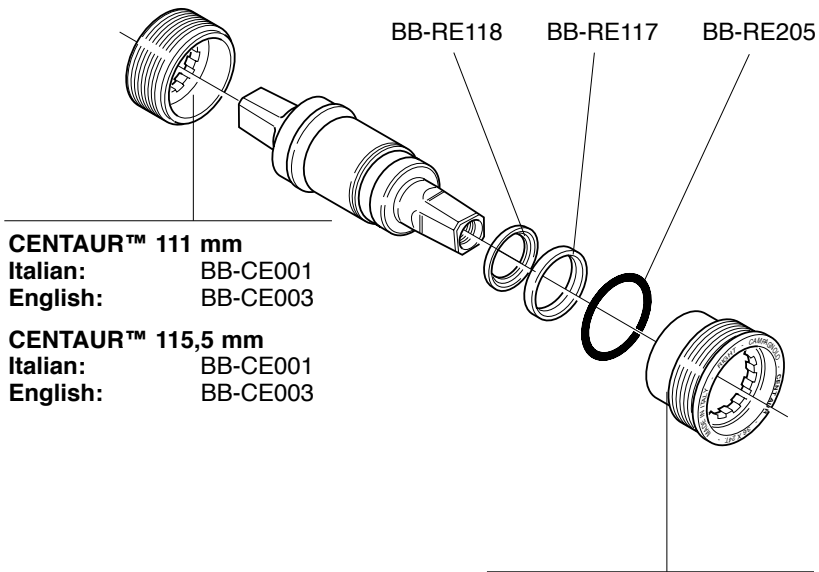

CENTAUR™ 111 mm
Italian: BB-CE001
English: BB-CE003

CENTAUR™ 115,5 mm
Italian: BB-CE001
English: BB-CE003

CENTAUR™ 111 mm
Italian: BB-CE002
English: BB-CE004

CENTAUR™ 115,5 mm
Italian: BB-CE102
English: BB-CE104

VELOCE™

111 mm

BB6-VL1I

BB6-VL1G

115,5 mm

BB6-VL5I

BB6-VL5G

ITALIAN:

BB-VL101 (VELOCE™)

ENGLISH:

BB-VL103 (VELOCE™)

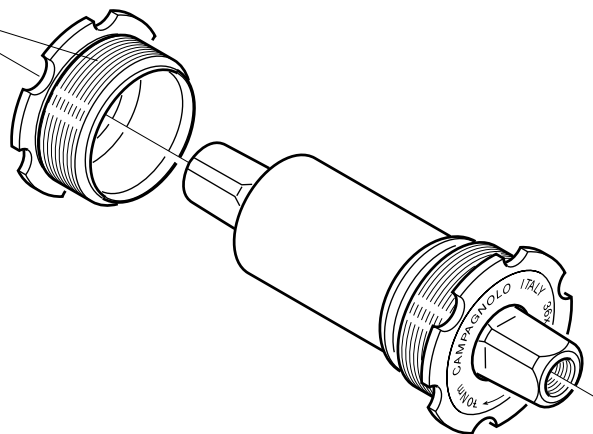

RECORD™ ULTRA-TORQUE™
Carbon 10s
FC7-RE...C

A	170 mm	FC-RE160
	172,5 mm	FC-RE162
	175 mm	FC-RE164
	177,5 mm	FC-RE166
	180 mm	FC-RE168
B	170 mm	FC-RE161
	172,5 mm	FC-RE163
	175 mm	FC-RE165
	177,5 mm	FC-RE167
	180 mm	FC-RE169
C	Z39	FC-RE139
D	Z52 for 39	FC-RE752
	Z53 for 39	FC-RE553

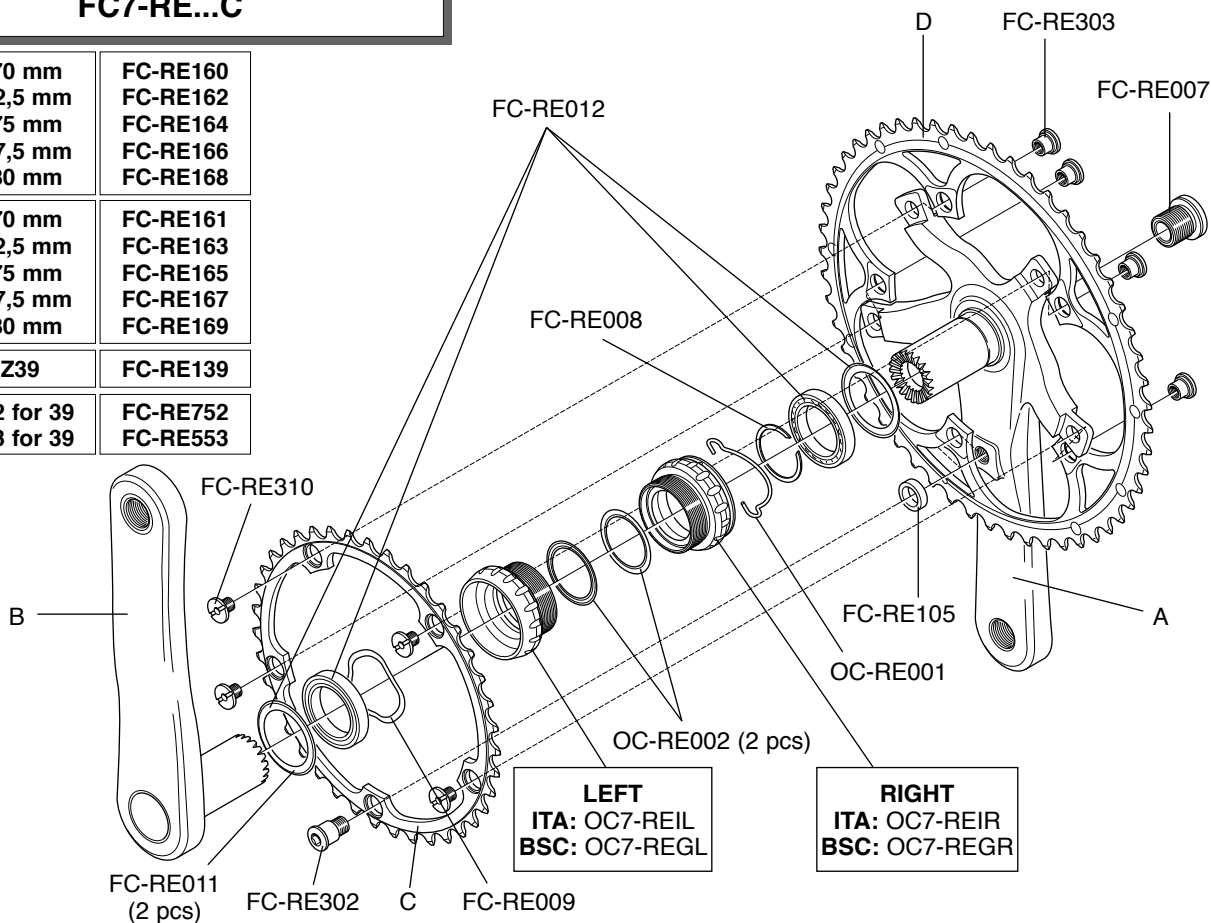

RECORD™ ULTRA-TORQUE™
CT™ Carbon 10s
FC7-RE...C

A	170 mm	FC-RE170
	172,5 mm	FC-RE172
	175 mm	FC-RE174
B	170 mm	FC-RE161
	172,5 mm	FC-RE163
	175 mm	FC-RE165
C	Z34	FC-RE034
	Z36	FC-RE036
D	Z48 for 34	FC-RE048
	Z50 for 34	FC-RE250
	Z50 for 36	FC-RE350

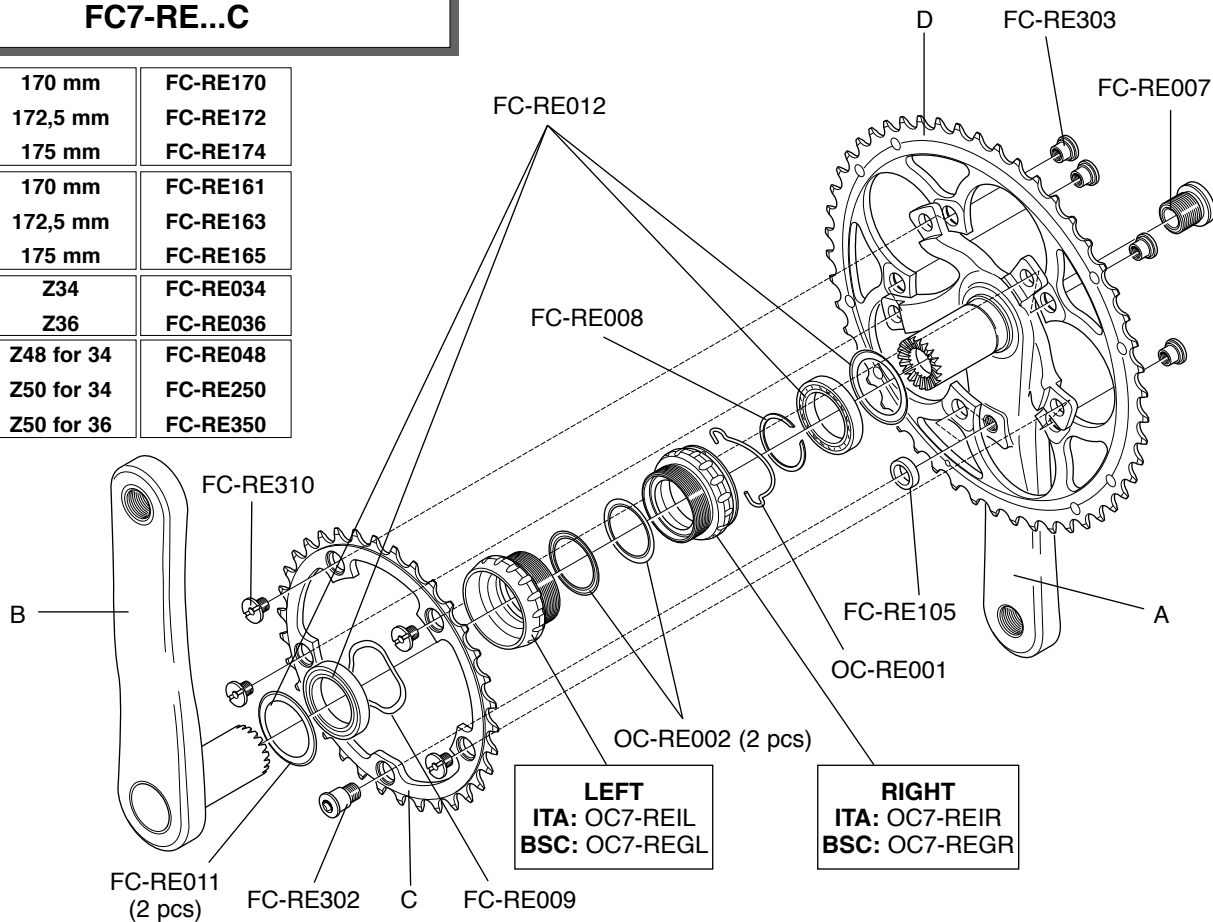

CRANKSET

RECORD™
PISTA™
FC01-REPL...

A	165 mm	FC-PI365
	170 mm	FC-PI370
B	165 mm	FC-PI465
	170 mm	FC-PI470
C	Z47	FC-PI047
	Z48	FC-PI048
	Z49	FC-PI049
	Z50	FC-PI050
	Z51	FC-PI051
	Z52	FC-PI052

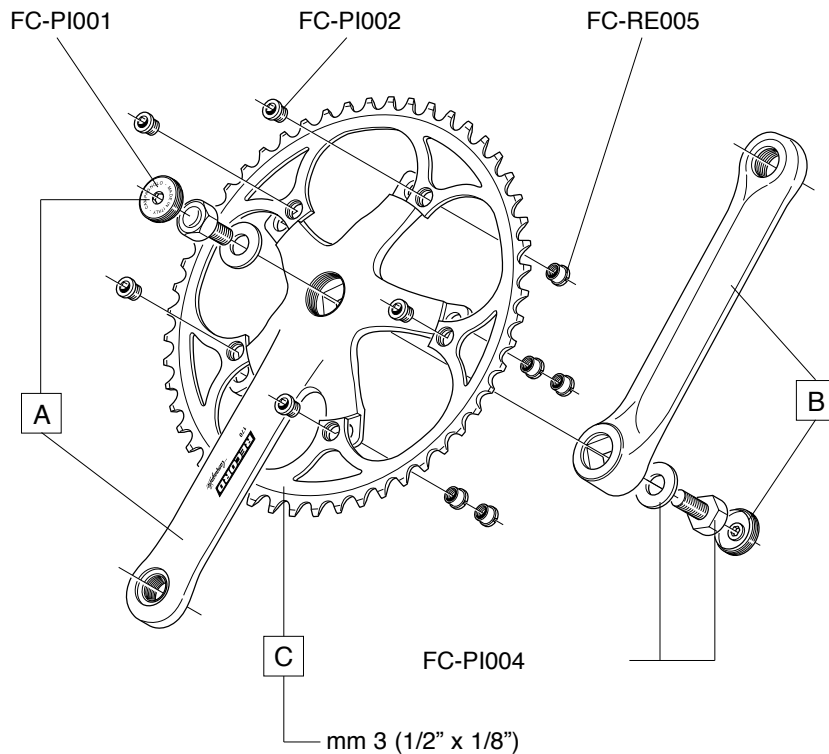

CHORUS™ ULTRA-TORQUE™
Carbon 10s
FC7-CH...C

A	170 mm	FC-CH200
	172,5 mm	FC-CH202
	175 mm	FC-CH204
B	170 mm	FC-CH201
	172,5 mm	FC-CH203
	175 mm	FC-CH205
C	Z39	FC-RE139
D	Z52 for 39	FC-RE752
	Z53 for 39	FC-RE553

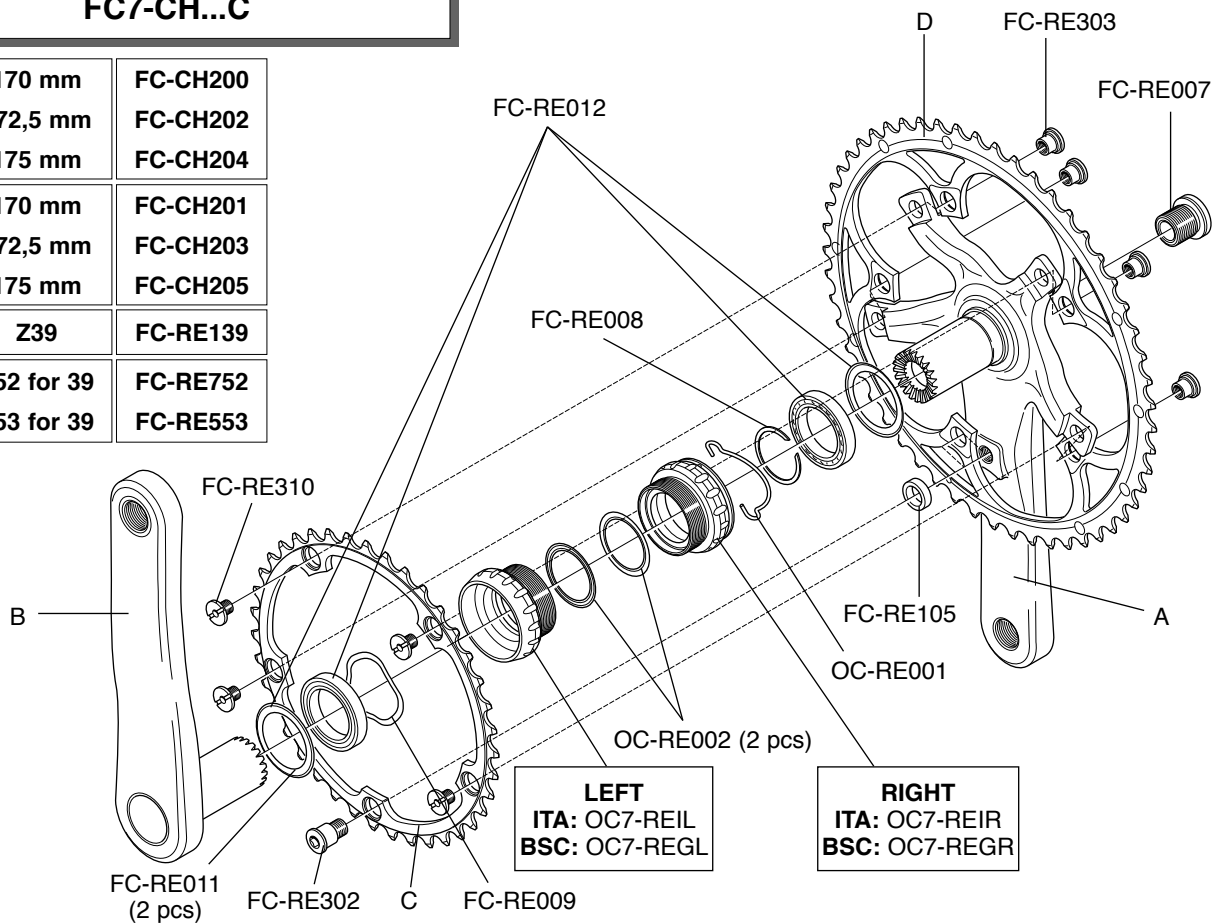

CHORUS™ ULTRA-TORQUE™
CT™ Carbon 10s
FC7-CH...C

A	170 mm	FC-CH210
	172,5 mm	FC-CH212
	175 mm	FC-CH214
B	170 mm	FC-CH201
	172,5 mm	FC-CH203
	175 mm	FC-CH205
C	Z34	FC-RE034
	Z36	FC-RE036
D	Z48 for 34	FC-RE048
	Z50 for 34	FC-RE250
	Z50 for 36	FC-RE350

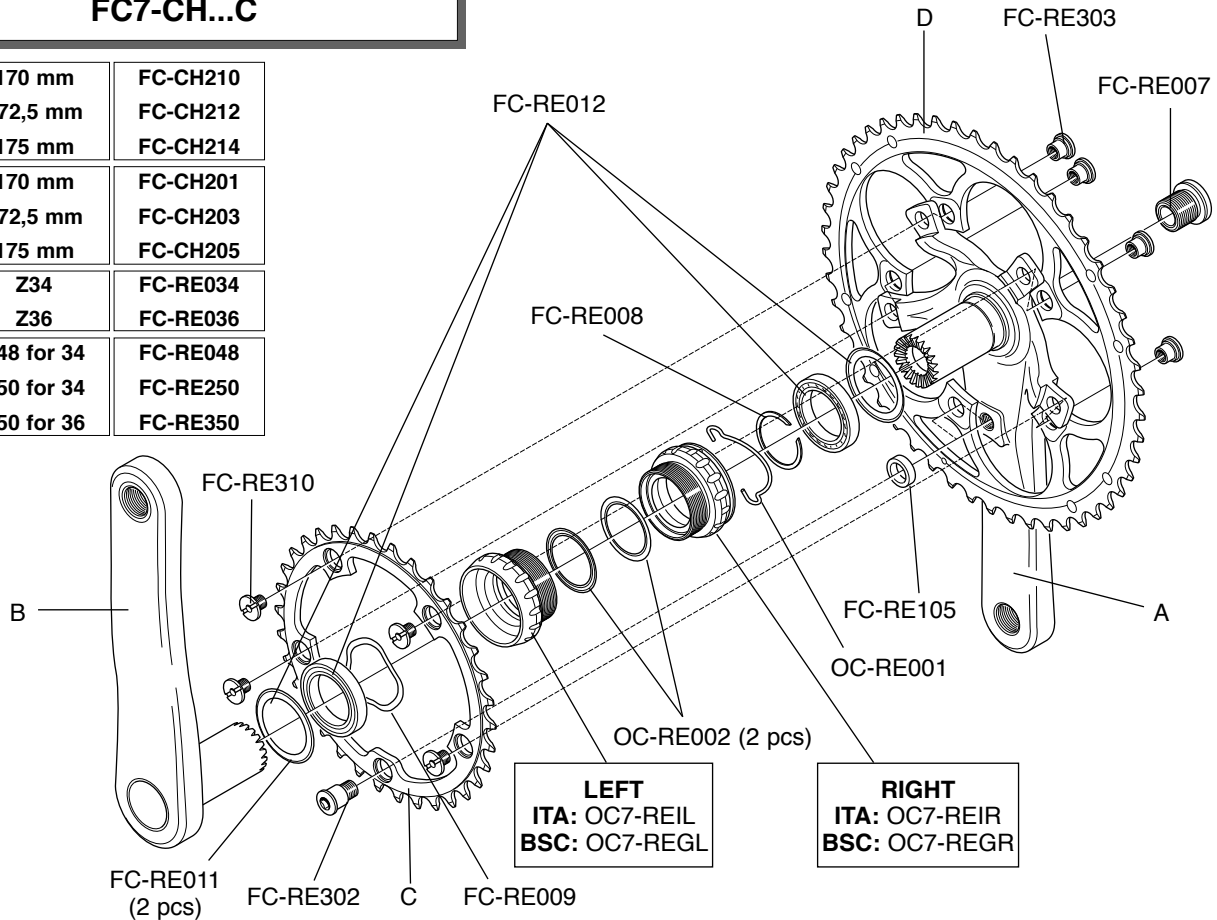

CENTAUR™ ULTRA-TORQUE™

Carbon 10s FC8-CE...C

A	170 mm	FC-CE220
	172,5 mm	FC-CE222
	175 mm	FC-CE224
B	170 mm	FC-CE221
	172,5 mm	FC-CE223
	175 mm	FC-CE225
C	Z39	FC-CE039
D	Z52 for 39	FC-CE052
	Z53 for 39	FC-CE153

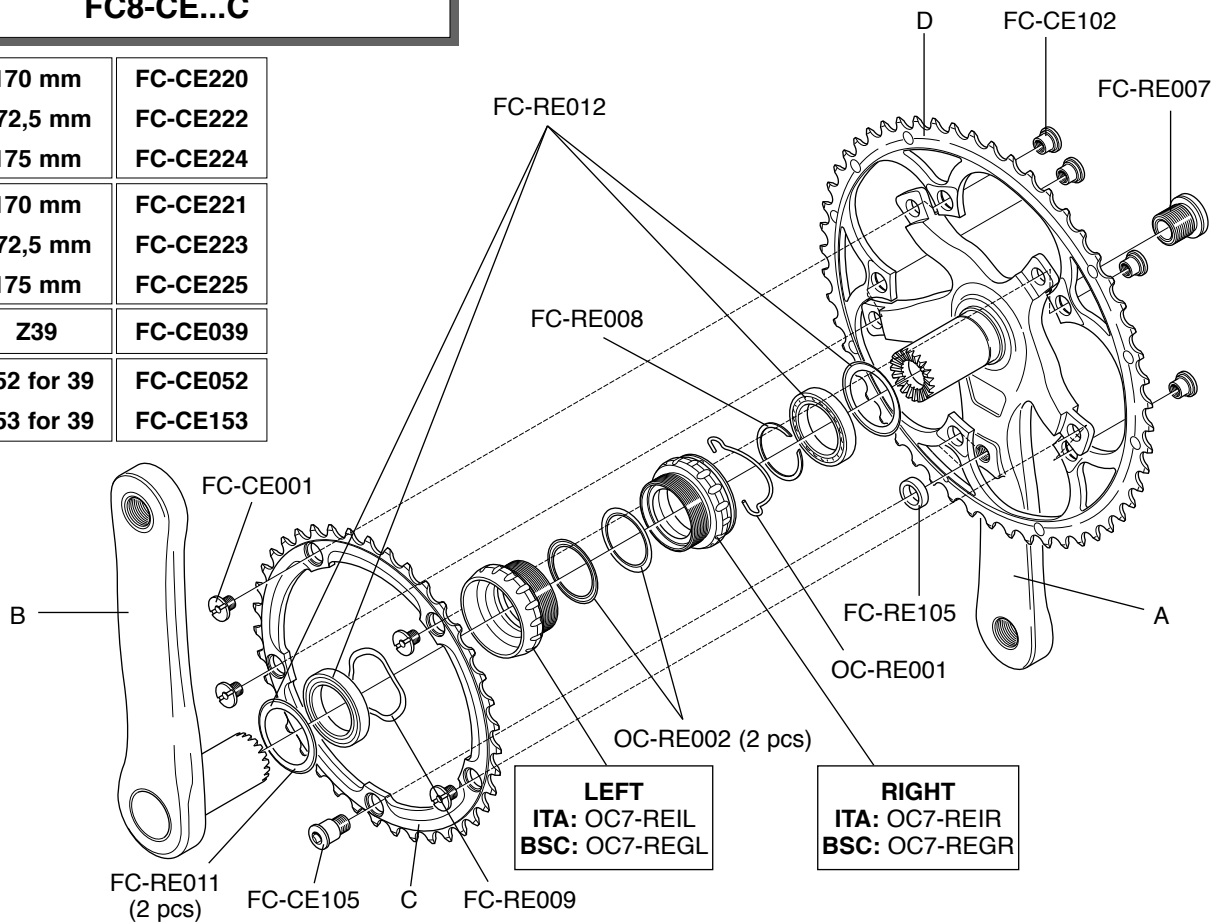

CENTAUR™ ULTRA-TORQUE™
CT™ Carbon 10s
FC8-CE...C

A	170 mm	FC-CE226
	172,5 mm	FC-CE228
	175 mm	FC-CE230
B	170 mm	FC-CE221
	172,5 mm	FC-CE223
	175 mm	FC-CE225
C	Z34	FC-CE134
D	Z50 for 34	FC-CE350

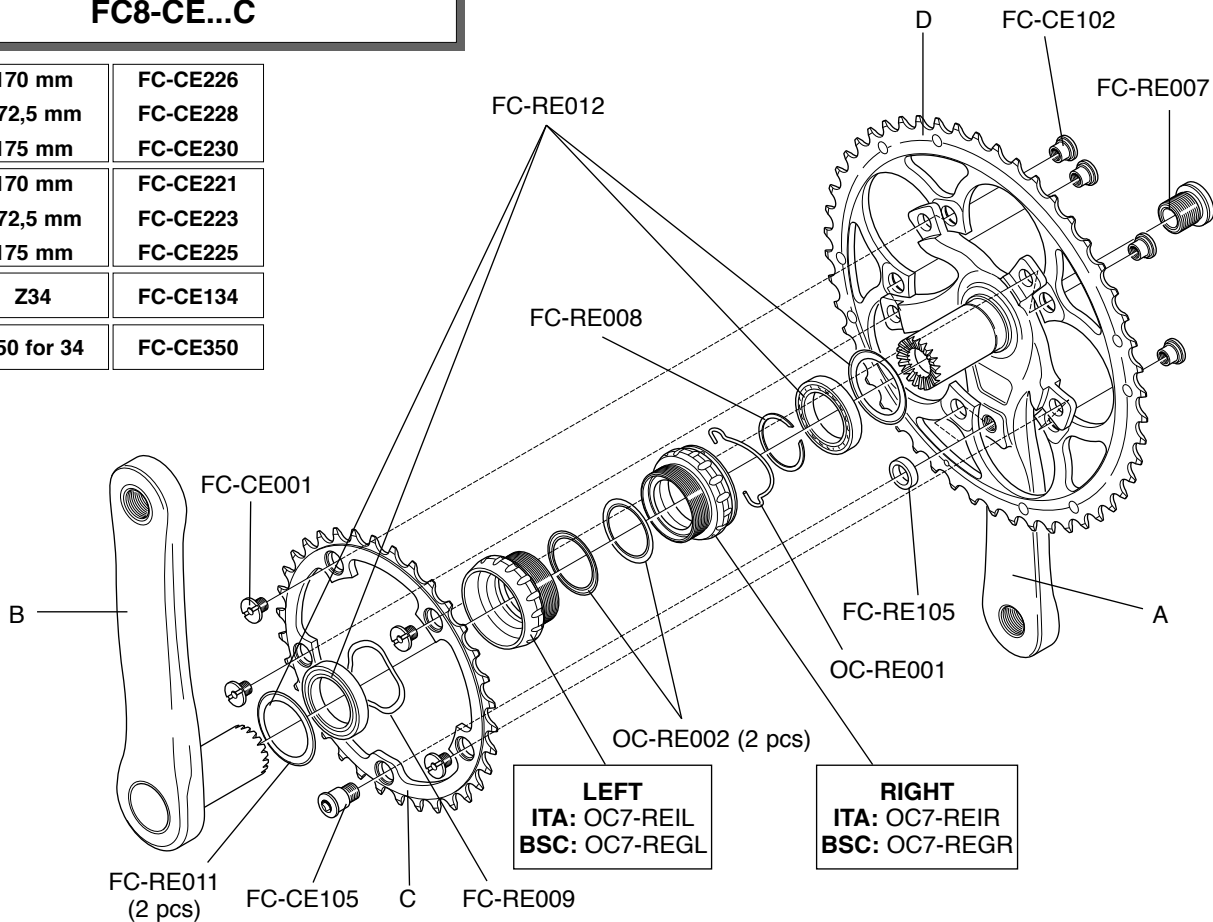

CENTAUR™ ULTRA-TORQUE™

10s
FC7-CE...

A	170 mm	FC-CE190
	172,5 mm	FC-CE192
	175 mm	FC-CE194
B	170 mm	FC-CE191
	172,5 mm	FC-CE193
	175 mm	FC-CE195
C	Z39	FC-RE039
D	Z53 for 39	FC-RE453

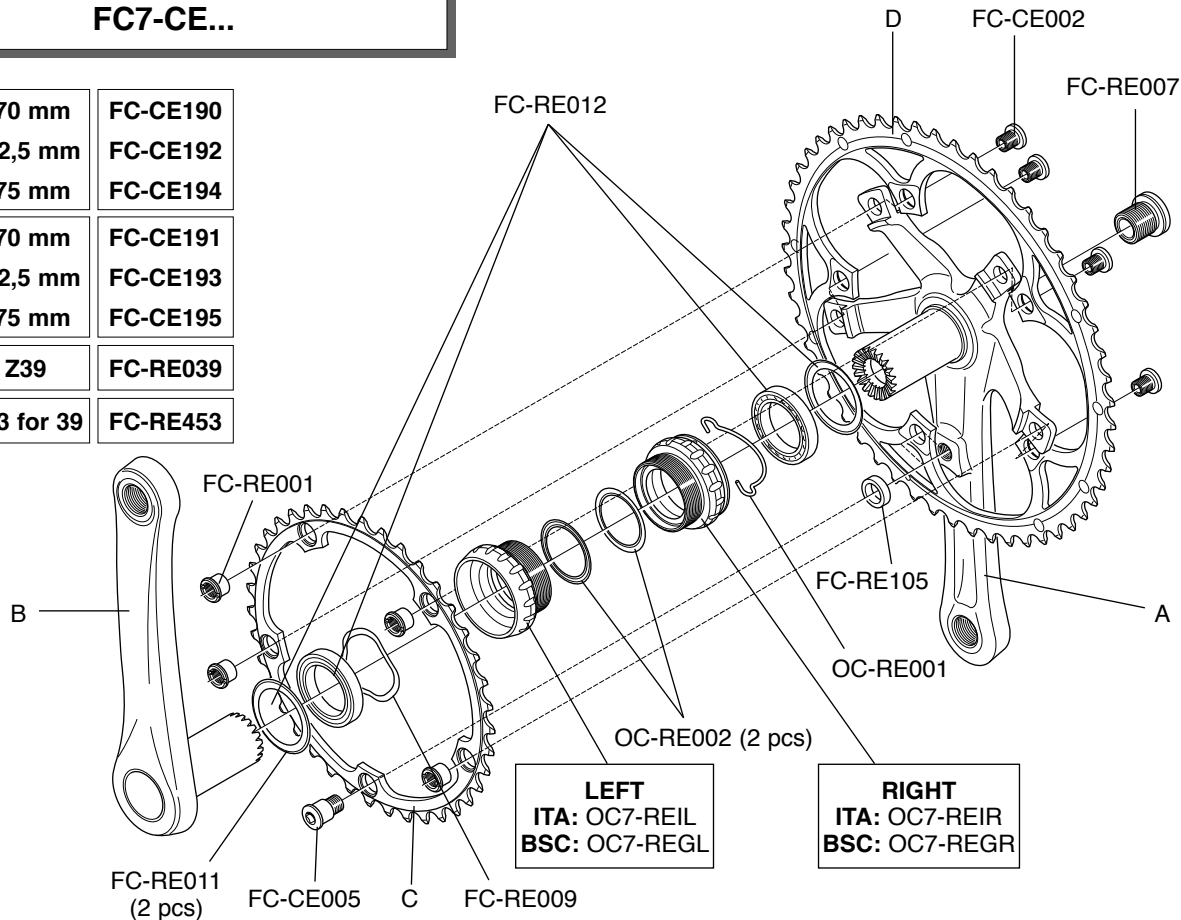

CRANKSET

CRANKSET

CENTAUR™ ULTRA-TORQUE™

CT™ 10s

FC7-CE...

A	170 mm	FC-CE140
	172,5 mm	FC-CE142
	175 mm	FC-CE144
B	170 mm	FC-CE191
	172,5 mm	FC-CE193
	175 mm	FC-CE195
C	Z34	FC-CH134
D	Z50 for 34	FC-CH050

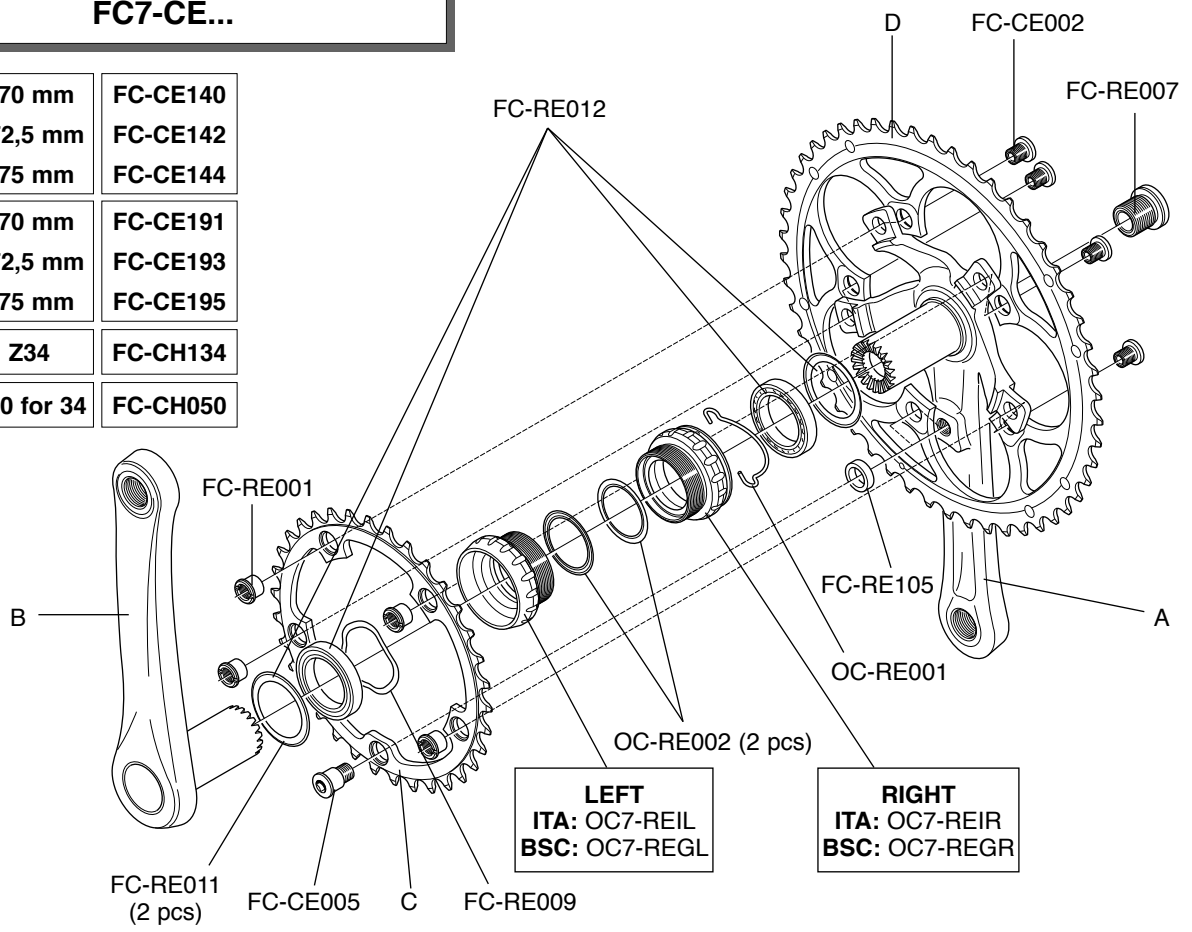

VELOCE™ ULTRA-TORQUE™ 10s FC7-VL...
VELOCE™ INFINITE™ ULTRA-TORQUE™ 10s
FC7-VLN...

		VELOCE™	INFINITE™
A	170 mm	FC-VL300	FC-VL310
	172,5 mm	FC-VL302	FC-VL312
	175 mm	FC-VL304	FC-VL314
B	170 mm	FC-VL233	FC-VL243
	172,5 mm	FC-VL235	FC-VL245
	175 mm	FC-VL237	FC-VL247
C	Z39	FC-VL139	FC-VL239
D	Z52 for 39	FC-VL352	---
	Z53 for 39	FC-VL153	FC-VL253

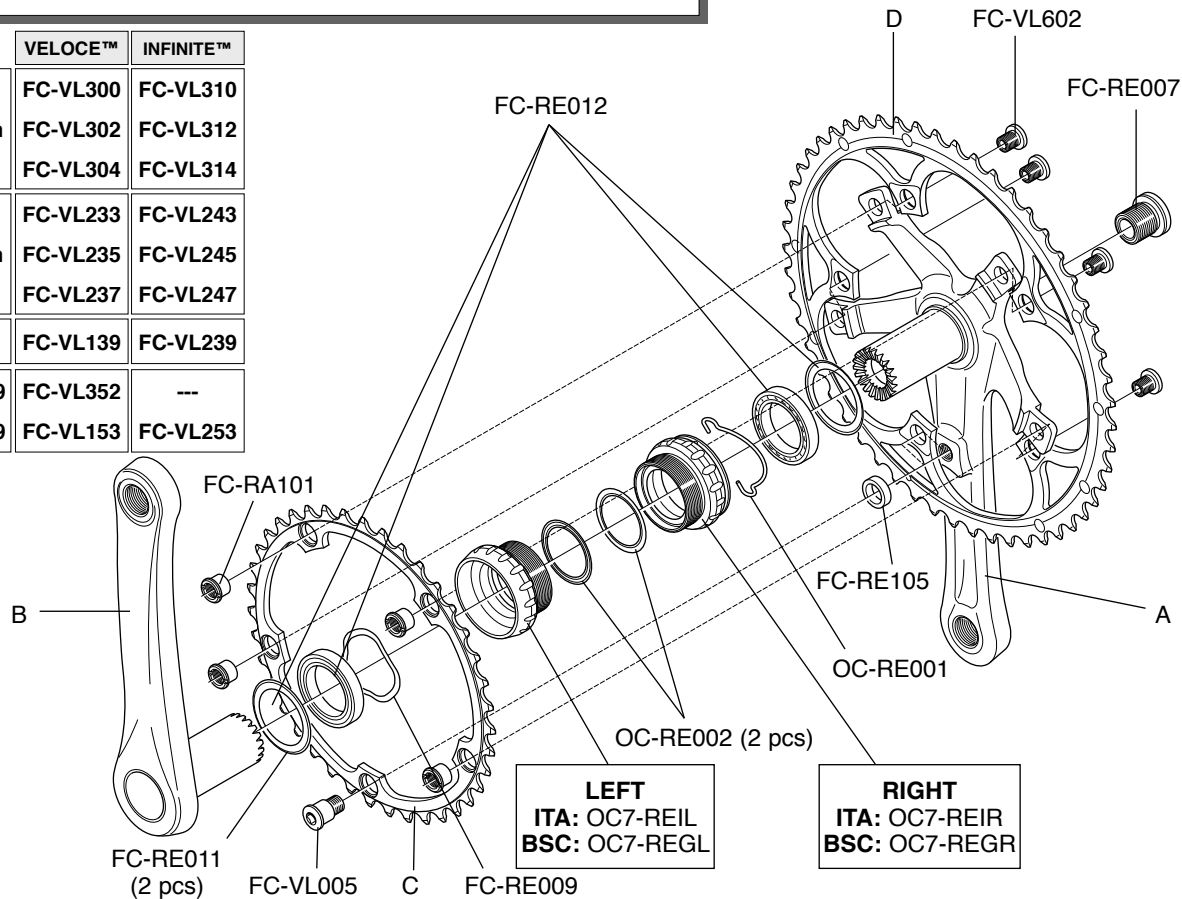

CRANKSET

VELOCE™ ULTRA-TORQUE™ CT™ 10s FC7-VL...
VELOCE™ INFINITE™ ULTRA-TORQUE™ CT™
10s FC7-VLN...

		VELOCE™	INFINITE™
A	170 mm	FC-VL232	FC-VL442
	172,5 mm	FC-VL234	FC-VL244
	175 mm	FC-VL236	FC-VL246
B	170 mm	FC-VL233	FC-VL243
	172,5 mm	FC-VL235	FC-VL245
	175 mm	FC-VL237	FC-VL247
C	Z34	FC-VL134	FC-VL334
D	Z50 for 34	FC-VL150	FC-VL250

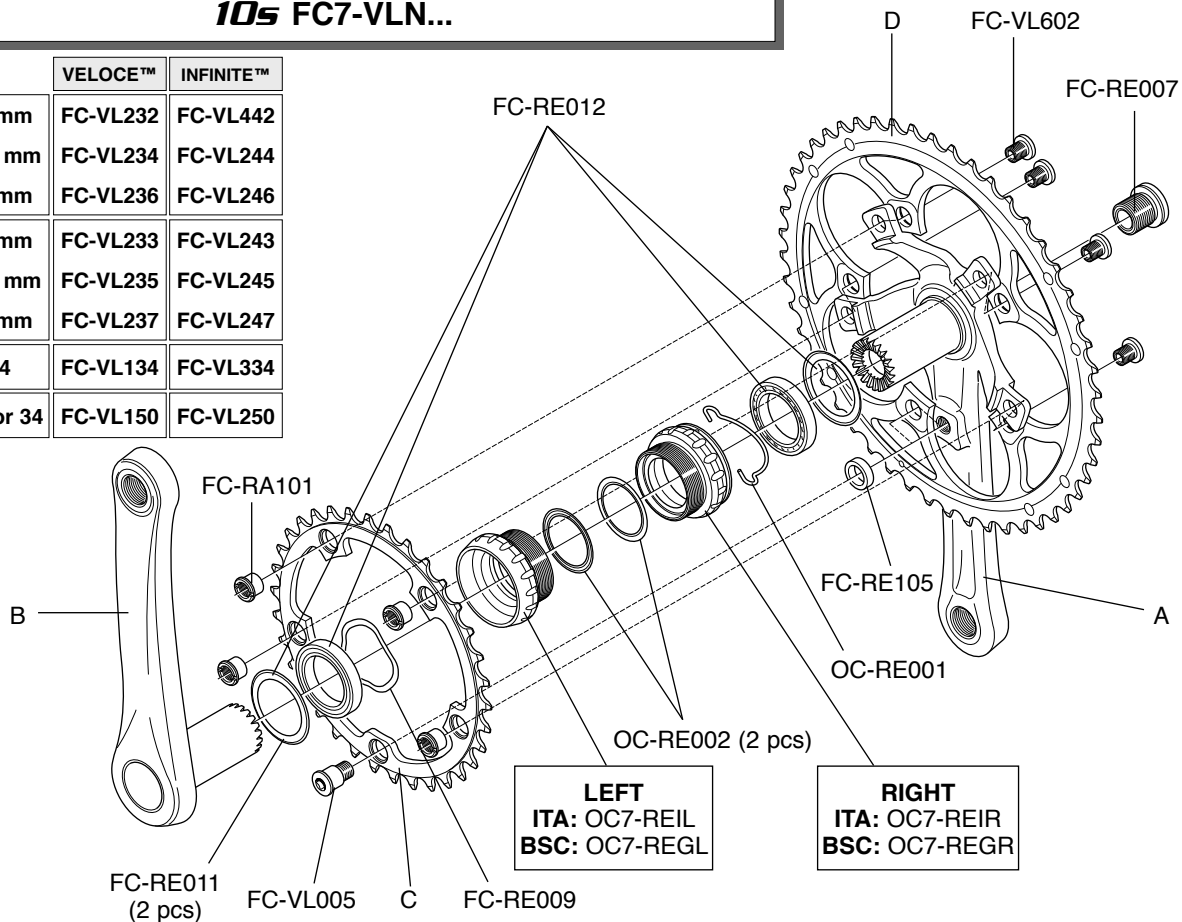

MIRAGE™ ULTRA-TORQUE™

10s
FC7-MI...

A	170 mm	FC-MI250
	172,5 mm	FC-MI252
	175 mm	FC-MI254
B	170 mm	FC-MI261
	172,5 mm	FC-MI263
	175 mm	FC-MI265
C	Z39	FC-MI239
D	Z53 for 39	FC-MI253

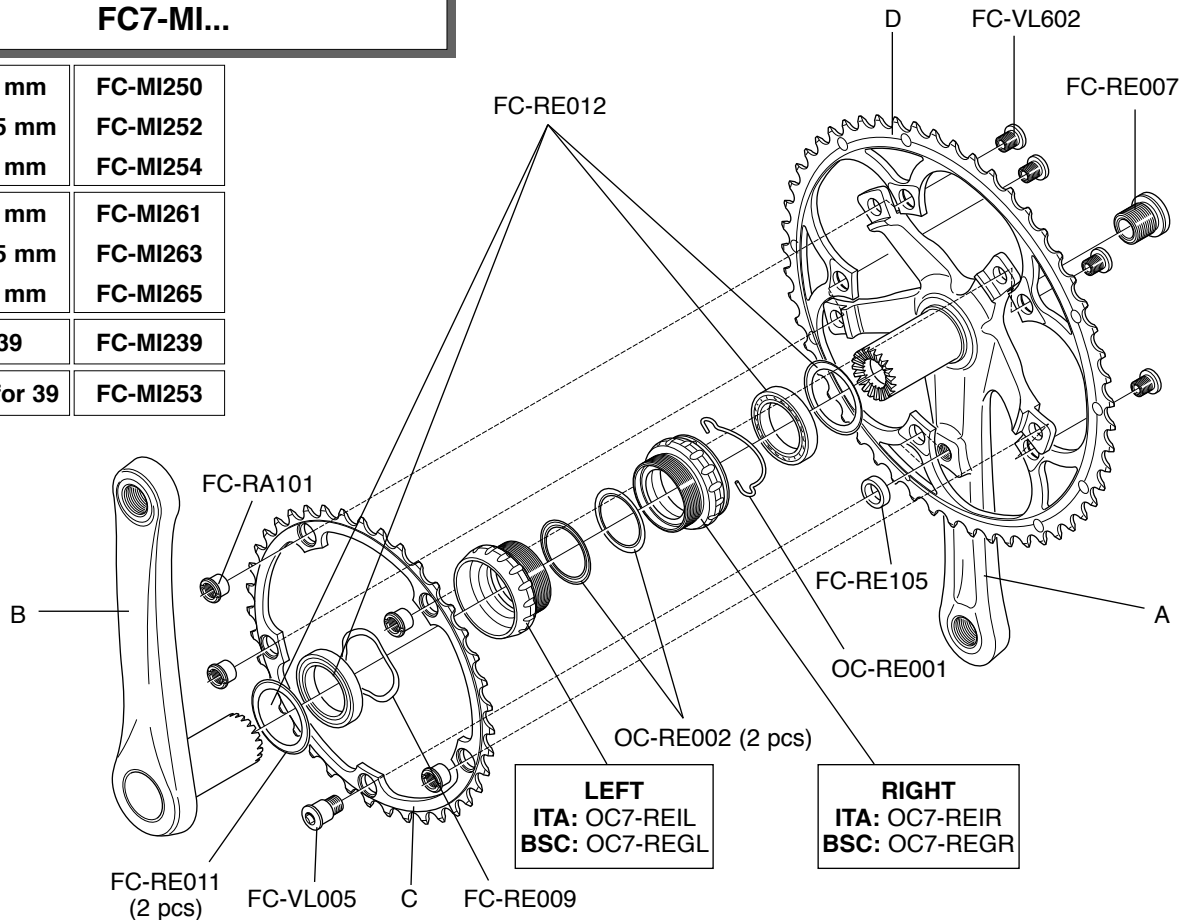

CRANKSET

XENON™ CT™

10s

FC7-XE...

A	170 mm	FC-XE270
	172,5 mm	FC-XE272
	175 mm	FC-XE274
B	170 mm	FC-XE271
	172,5 mm	FC-XE273
	175 mm	FC-XE275
C	Z34	FC-MIB034
D	Z50 for 34	FC-XE050

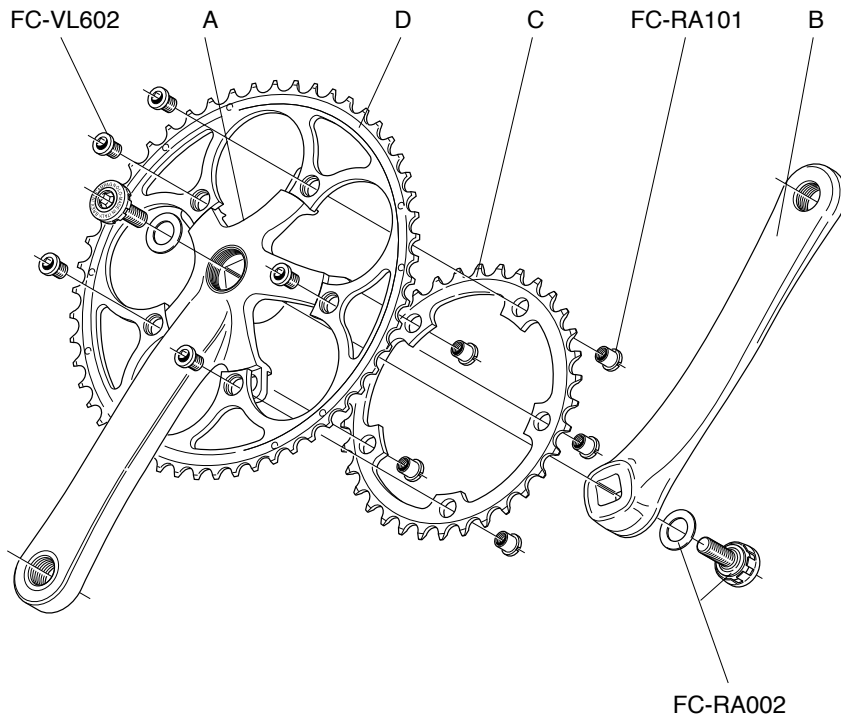

CRANKSET

COMP TRIPLE™ 10s FC7-CO....

A	170 mm	FC-CO312
	175 mm	FC-CO314
B	170 mm	FC-CO313
	175 mm	FC-CO315
C	Z30	FC-RE030
D	Z40 for 30	FC-CE040
	Z42 for 30	FC-CE042
E	Z50 for 40	FC-CE050
	Z53 for 42	FC-CE053

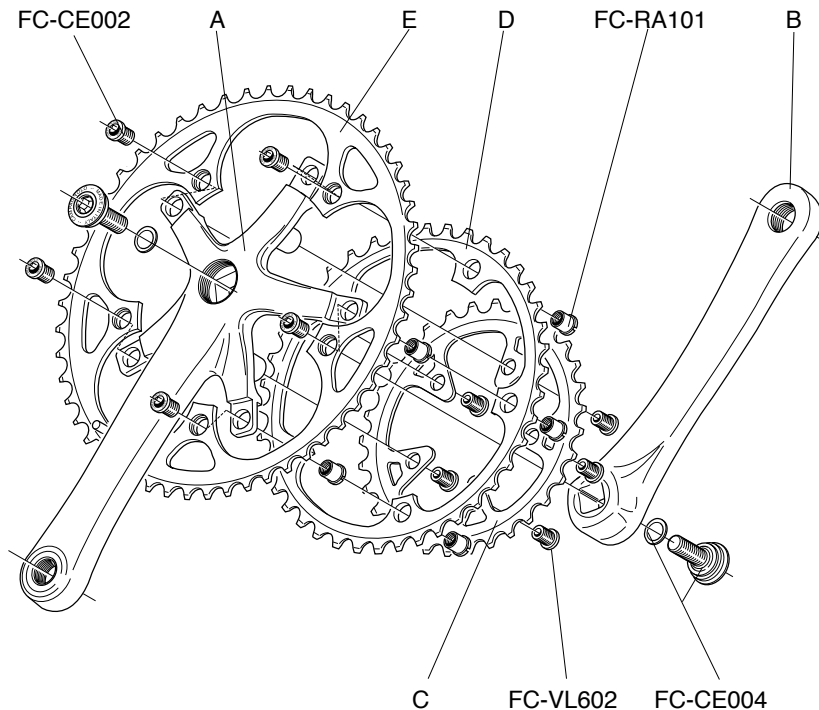

RACE TRIPLE™ 10S
FC7-RA...

A	170 mm	FC-RA926
	175 mm	FC-RA928
B	170 mm	FC-RA927
	175 mm	FC-RA929
C	Z30	FC-MIB030
D	Z42 for 30	FC-RA142
E	Z52 for 42	FC-RA052

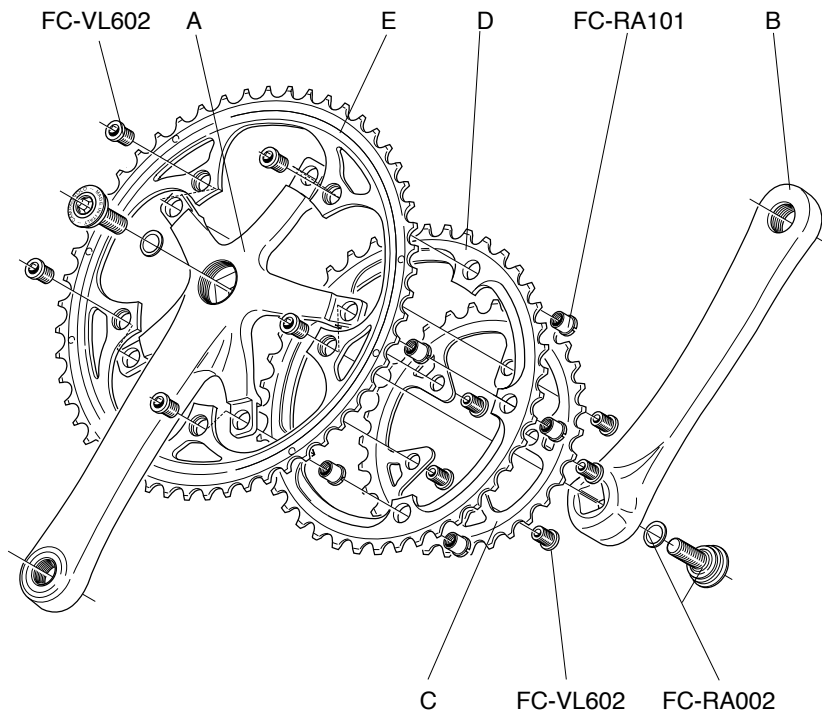

CHAMP TRIPLE™ 95 **FC7-CP...**

A	170 mm	FC-CP876
	175 mm	FC-CP878
B	170 mm	FC-CP877
	175 mm	FC-CP879
C	Z30	FC-MI030
D	Z42 for 30	FC-XE142
E	Z52 for 42	FC-XE252

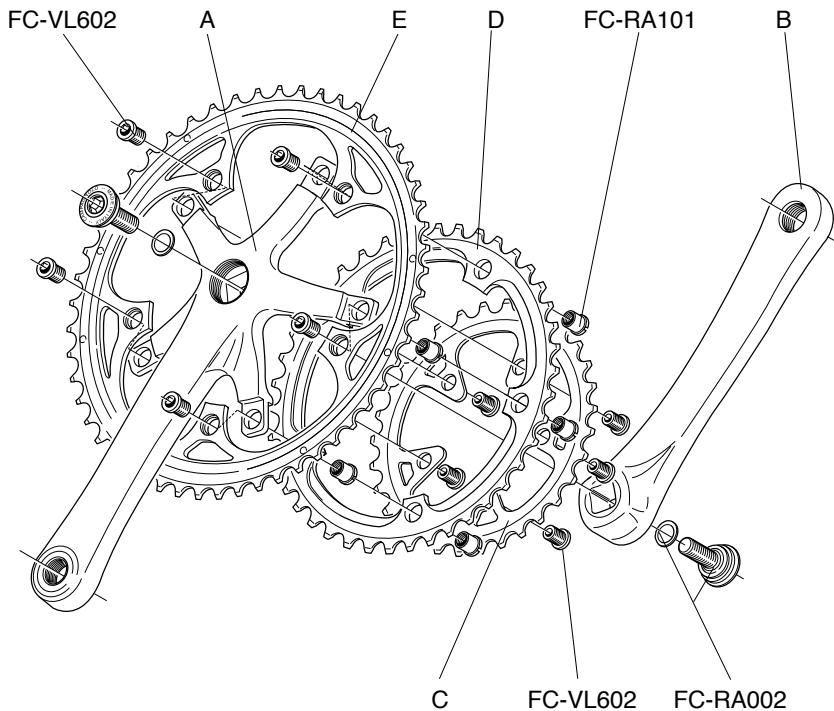

**TIME TRIAL™
CHAINRINGS**

9s	RECORD™ 10s	CHORUS™ 10s
FC-TH155: 55 for 42	FC-RETH155: 55 for 42	FC-CHTH155: 55 for 42
FC-TH255: 55 for 44	FC-RETH255: 55 for 44	FC-CHTH255: 55 for 44

9s	RECORD™ 10s	CHORUS™ 10s
FC-TH154: 54 for 42	FC-RETH154: 54 for 42	FC-CHTH154: 54 for 42
FC-TH254: 54 for 44	FC-RETH254: 54 for 44	FC-CHTH254: 54 for 44

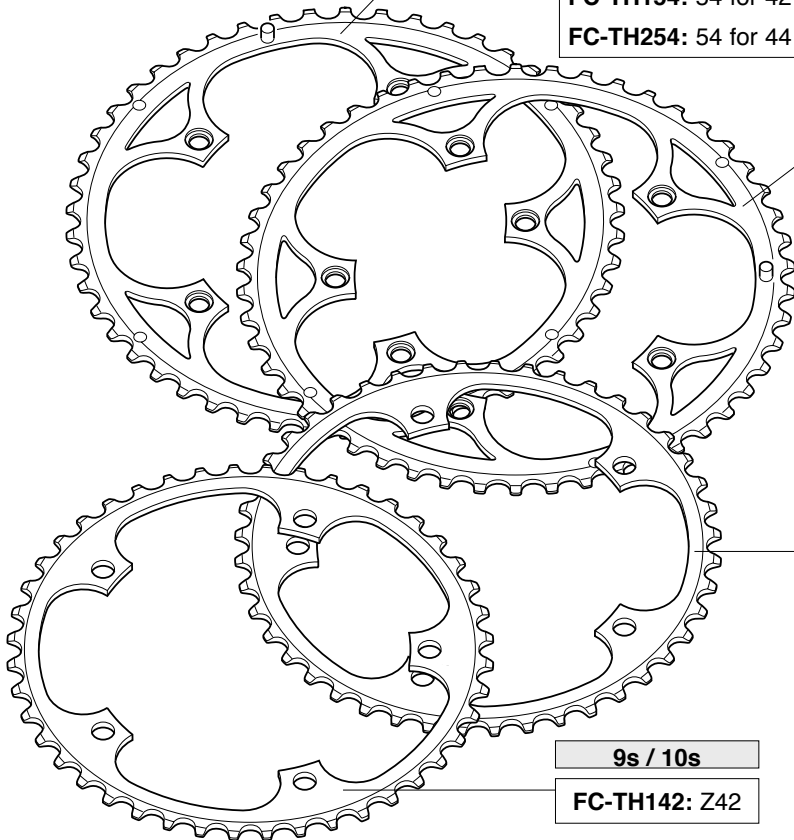

9s / 10s
FC-TH144: Z44

9s / 10s
FC-TH142: Z42

RECORD™ 10s
RD4-REXS
RD4-REXM

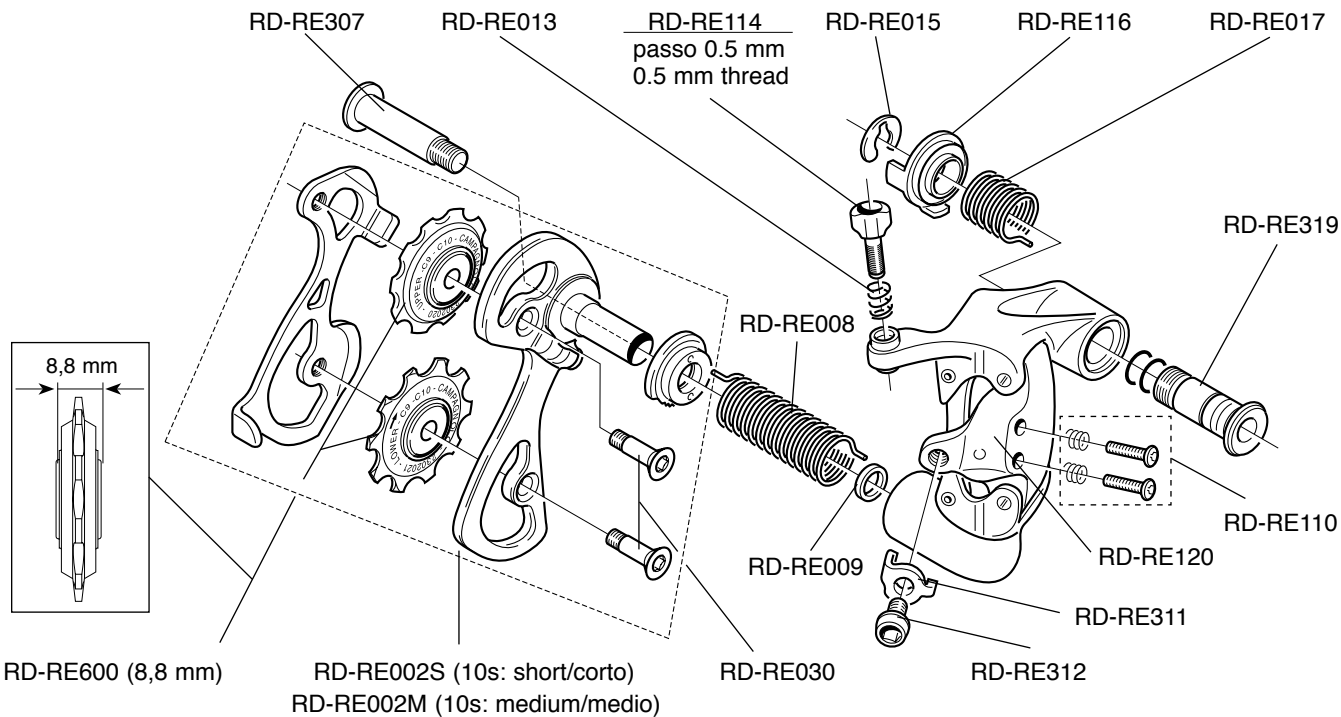

CHORUS™ 10s
RD4-CHXS
RD4-CHXM

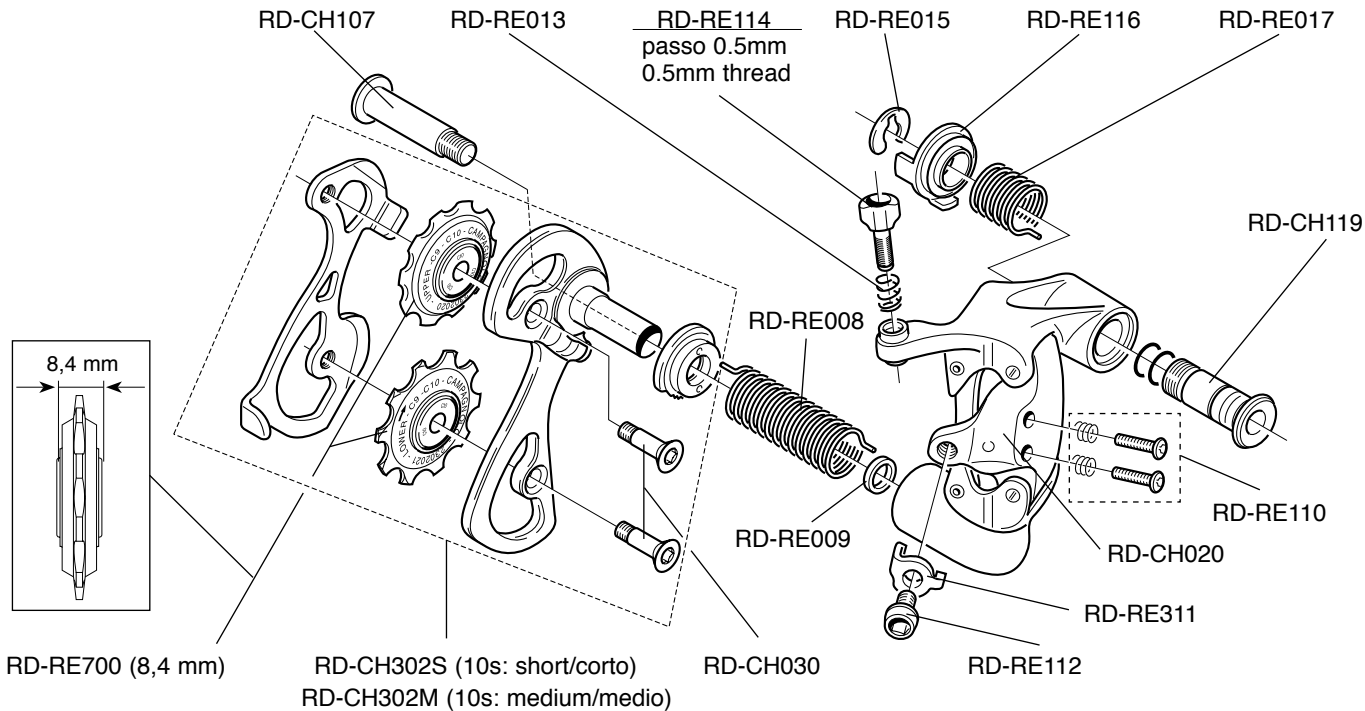

CENTAUR™ 10s
RD7-CEXS
RD7-CEXM

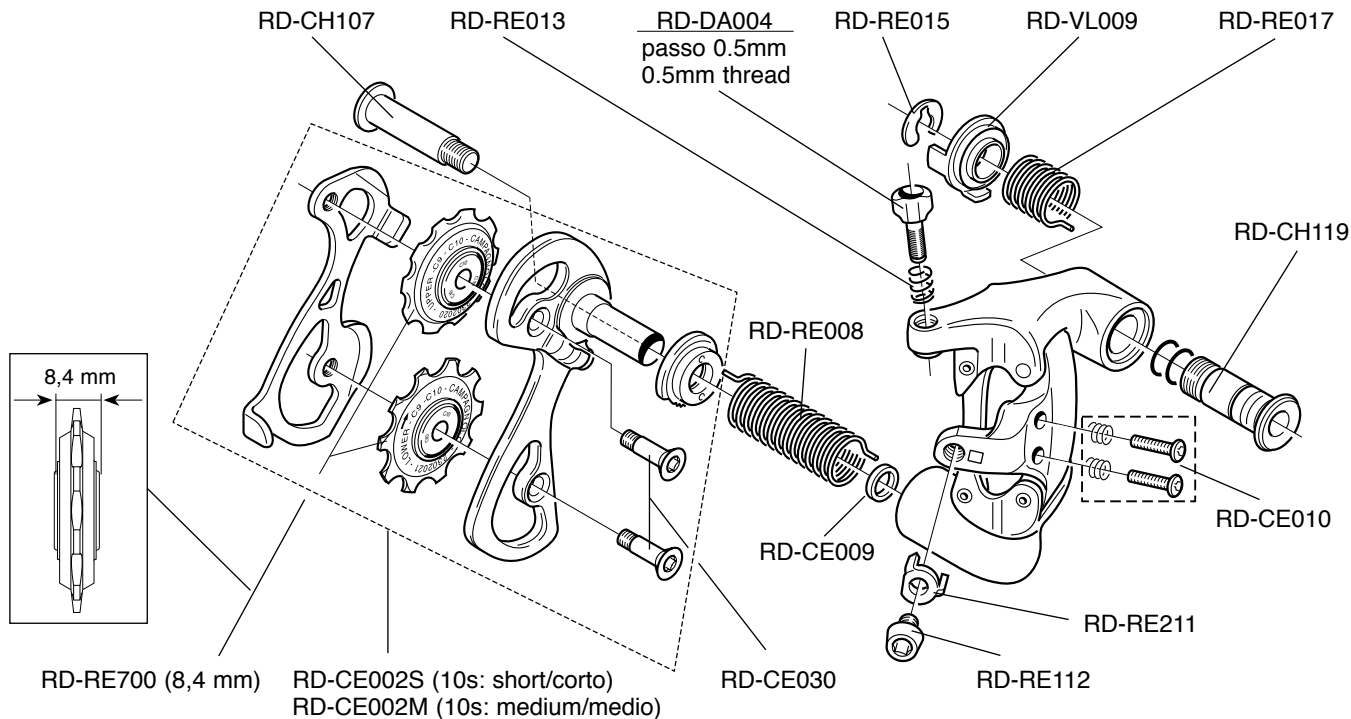

VELOCE™ 10s
RD7-VLXS - RD7-VLXM
VELOCE™ INFINITE™ 10s
RD7-VLNXS - RD7-VLNXM

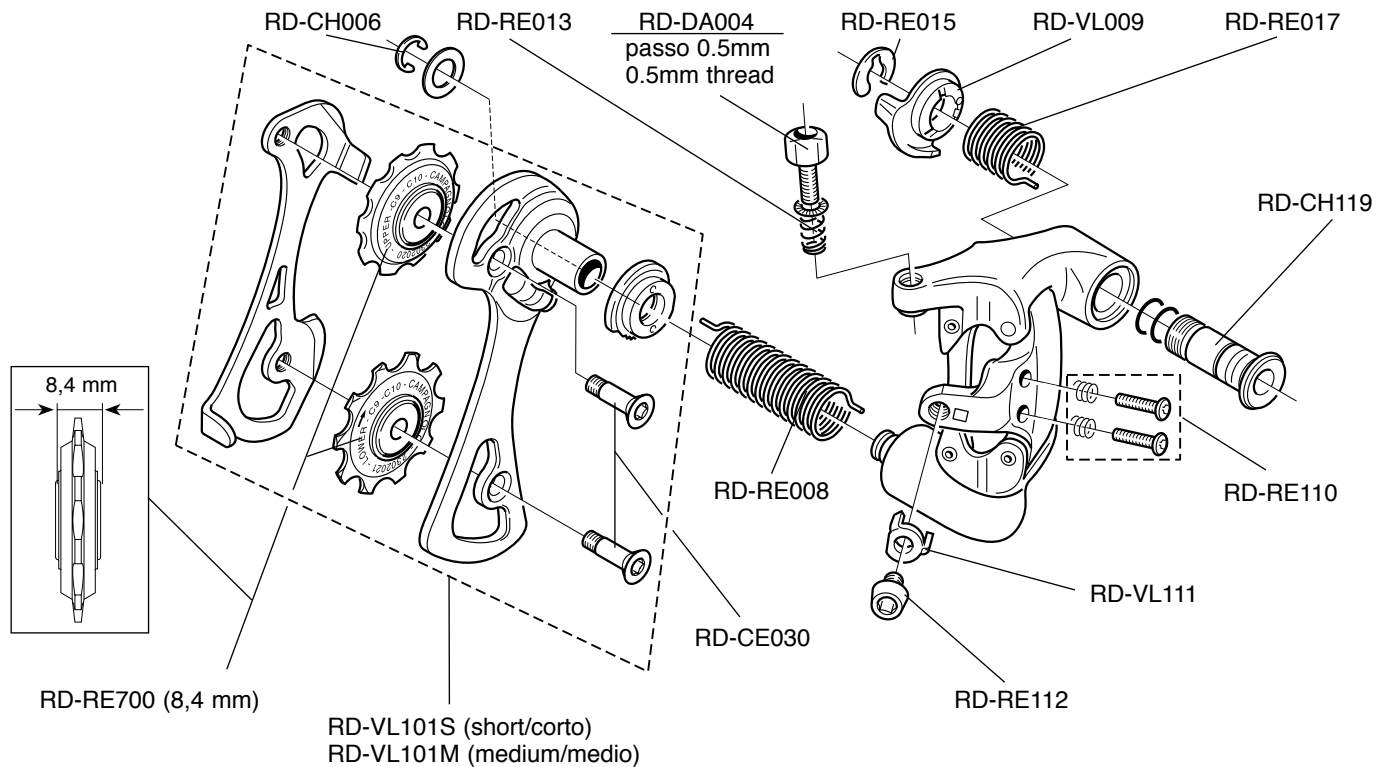

MIRAGE™ 10s
RD7-MIXS
RD7-MIXM

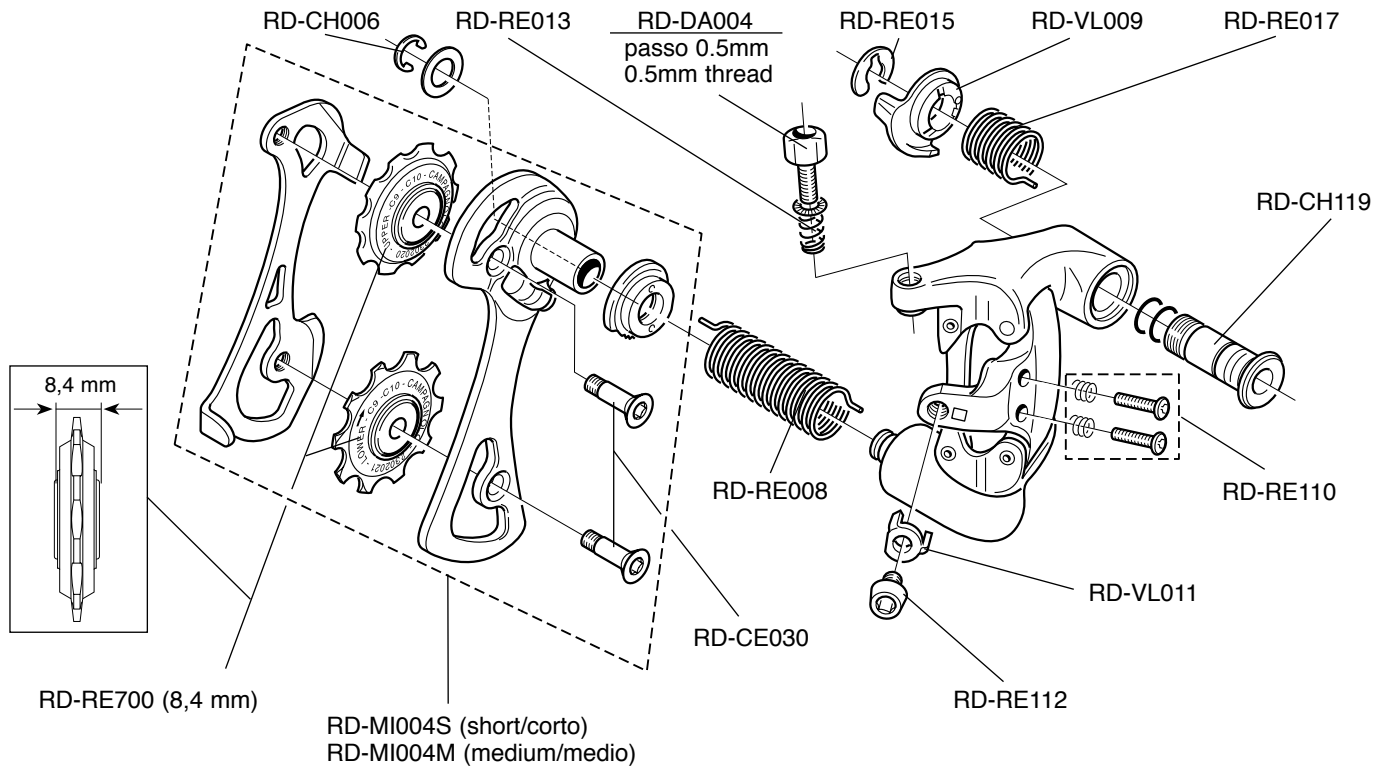

XENON™ 10s
RD7-XEXS
RD7-XEXM

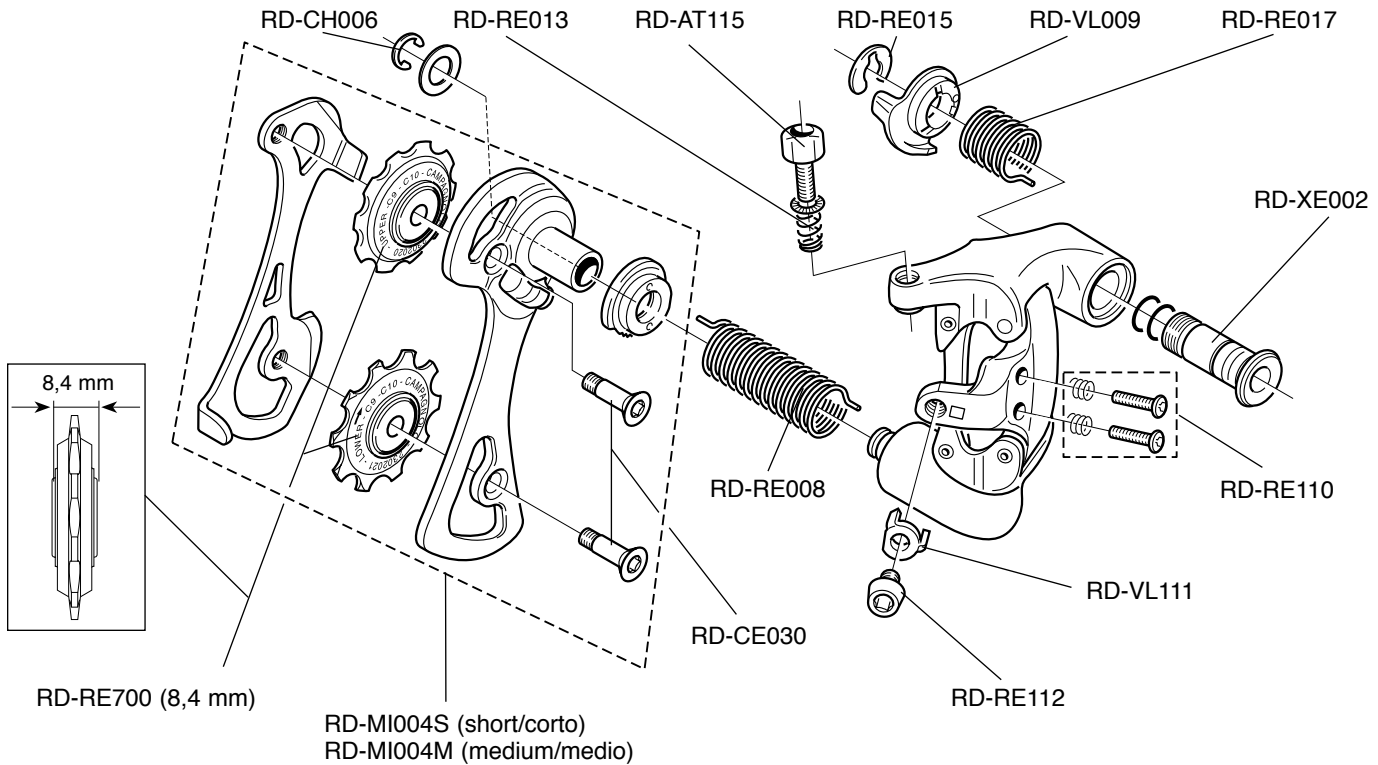

RACE TRIPLE™ 10s
RD7-RAXL

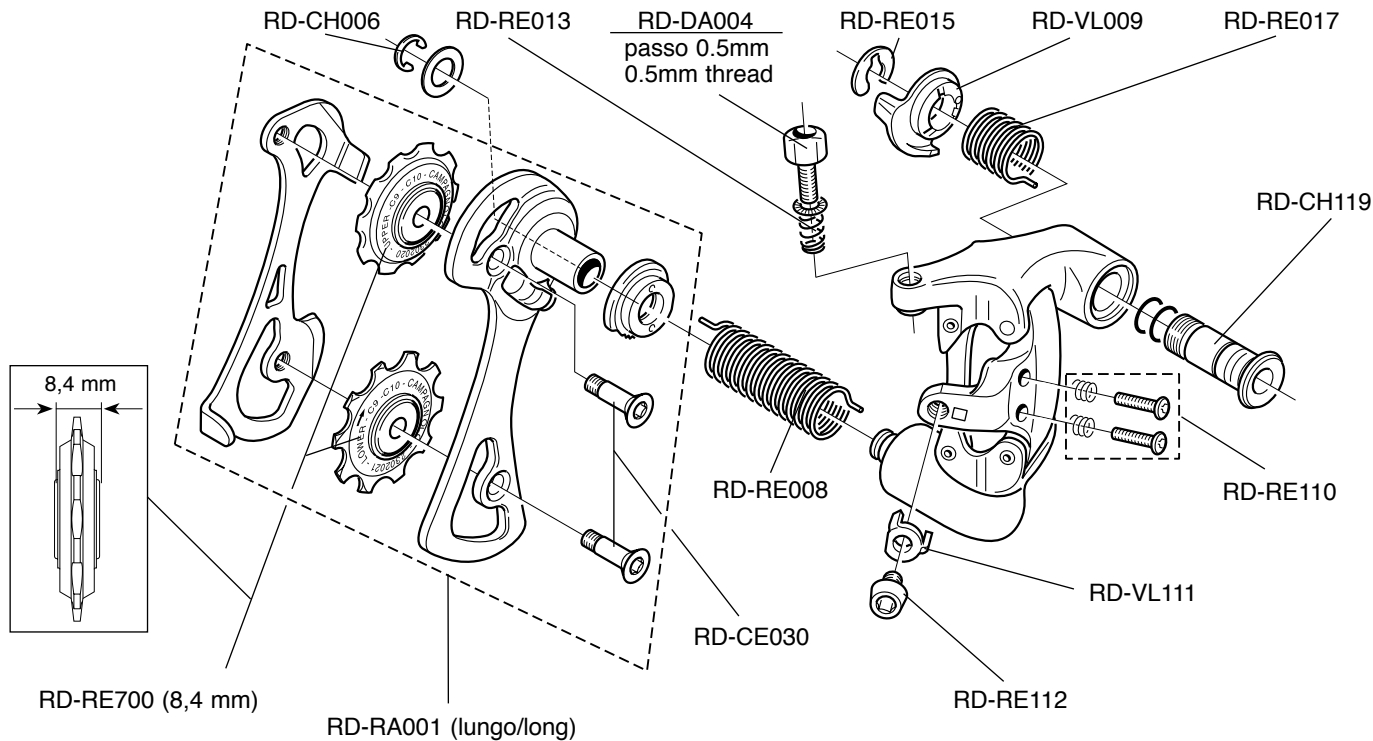

CHAMP TRIPLE™

9s
RD7-CP9L

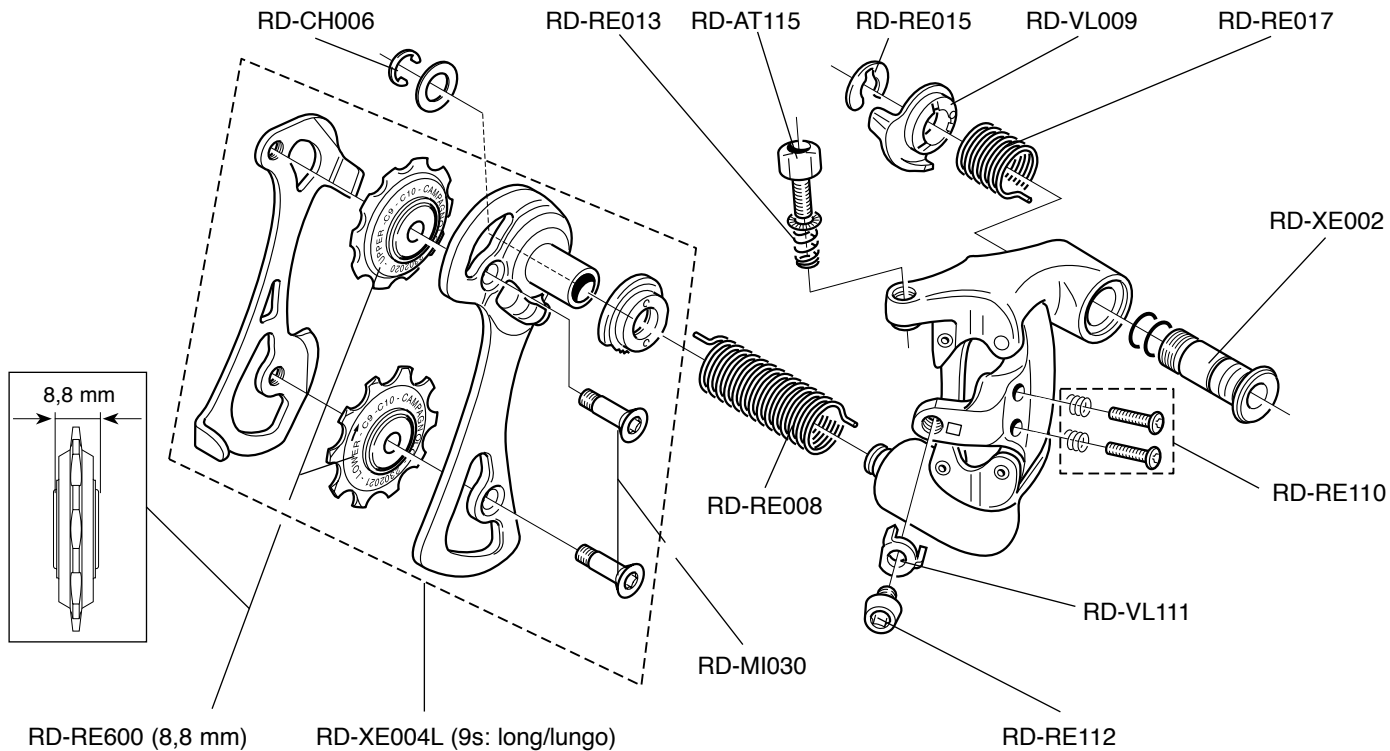

RECORD™ QS™

10s

FD8-RE2..

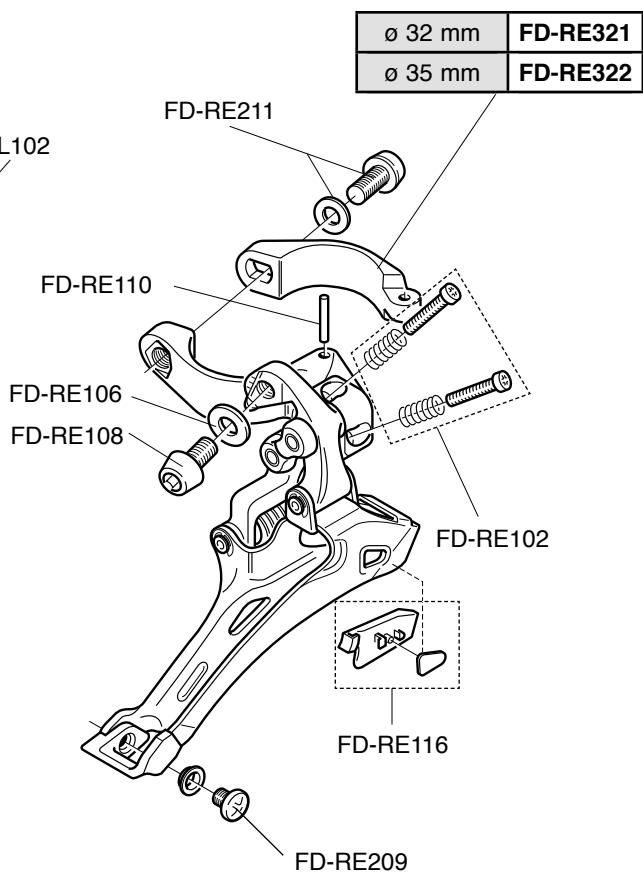
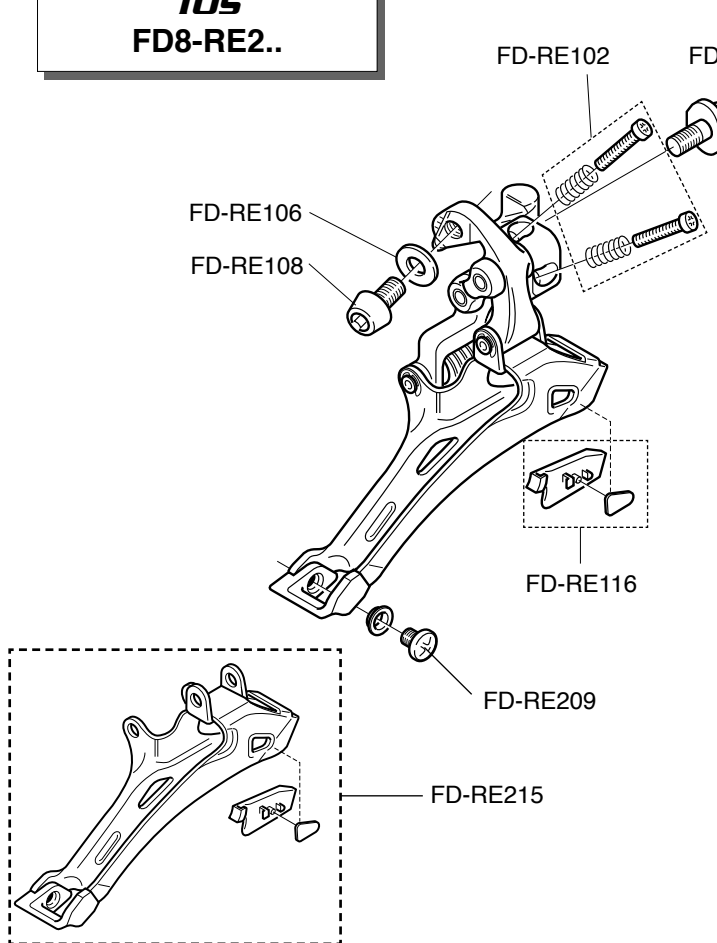

FRONT DERAILLEUR

CHORUS™ QS™

10s

FD8-CH2..

∅ 32 mm	FD-RE321
∅ 35 mm	FD-RE322

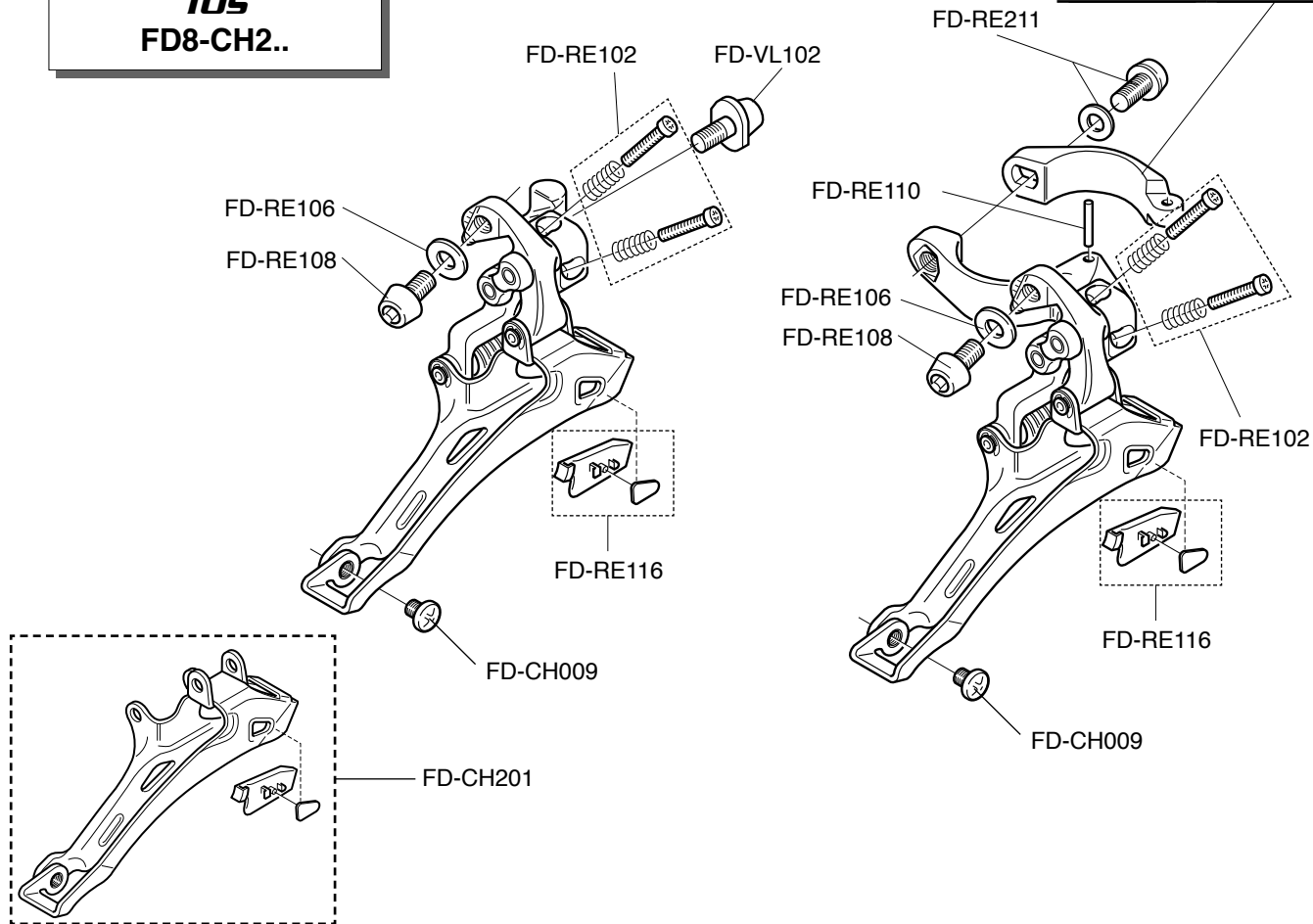

CENTAUR™ QS™
10s
FD8-CE2..

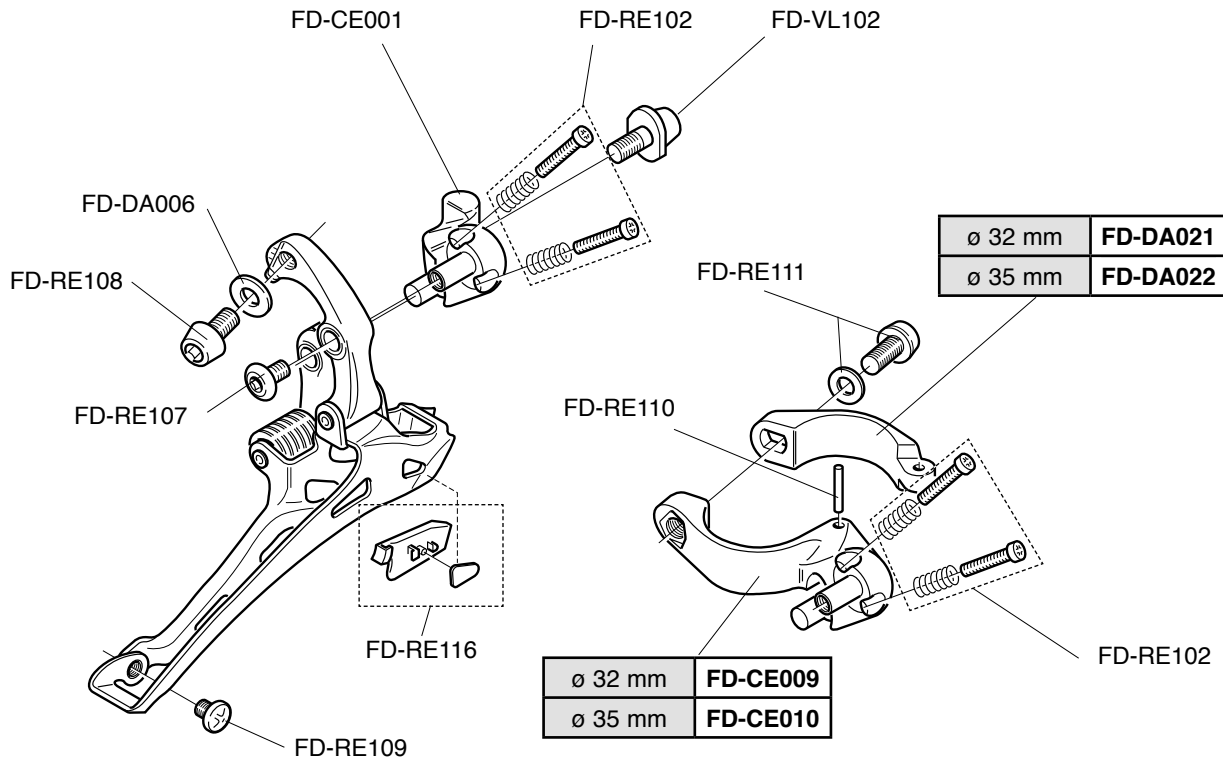

VELOCE™ QS™ 10s
FD8-VL2..
VELOCE™ INFINITE™ QS™ 10s
FD8-VLN2..

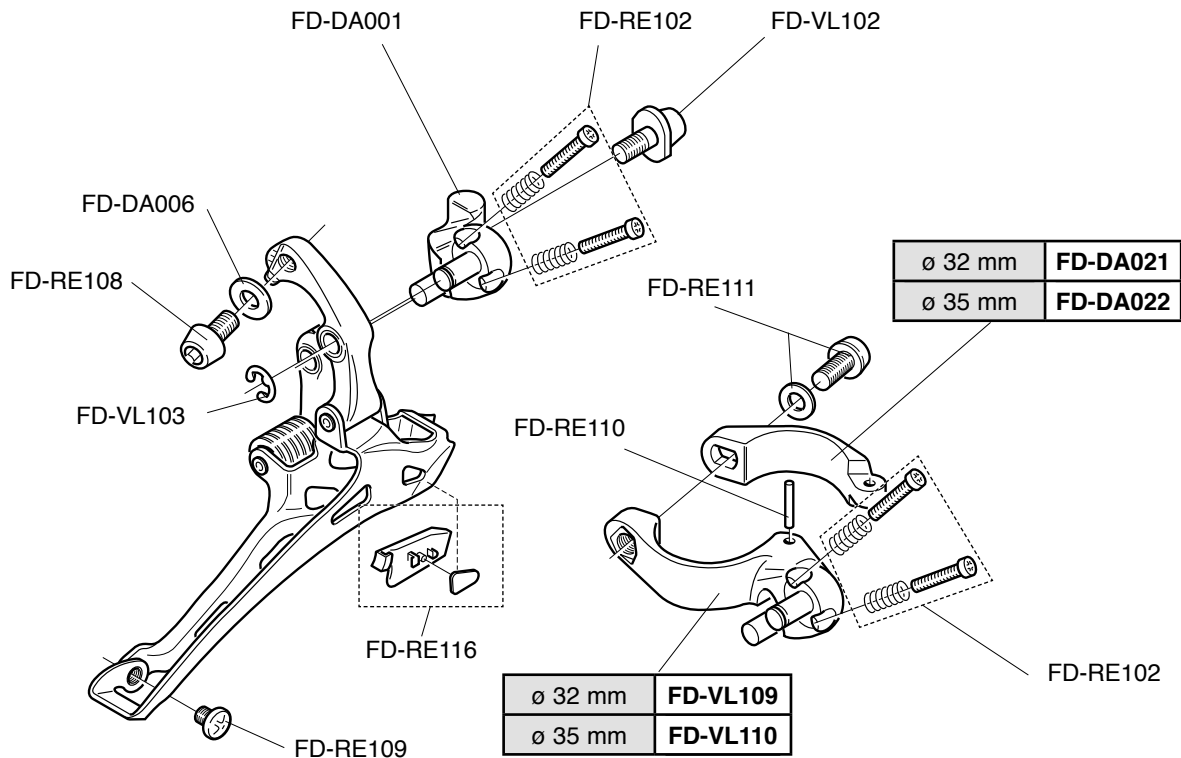

MIRAGE™ QS™
10s
FD8-MI2..

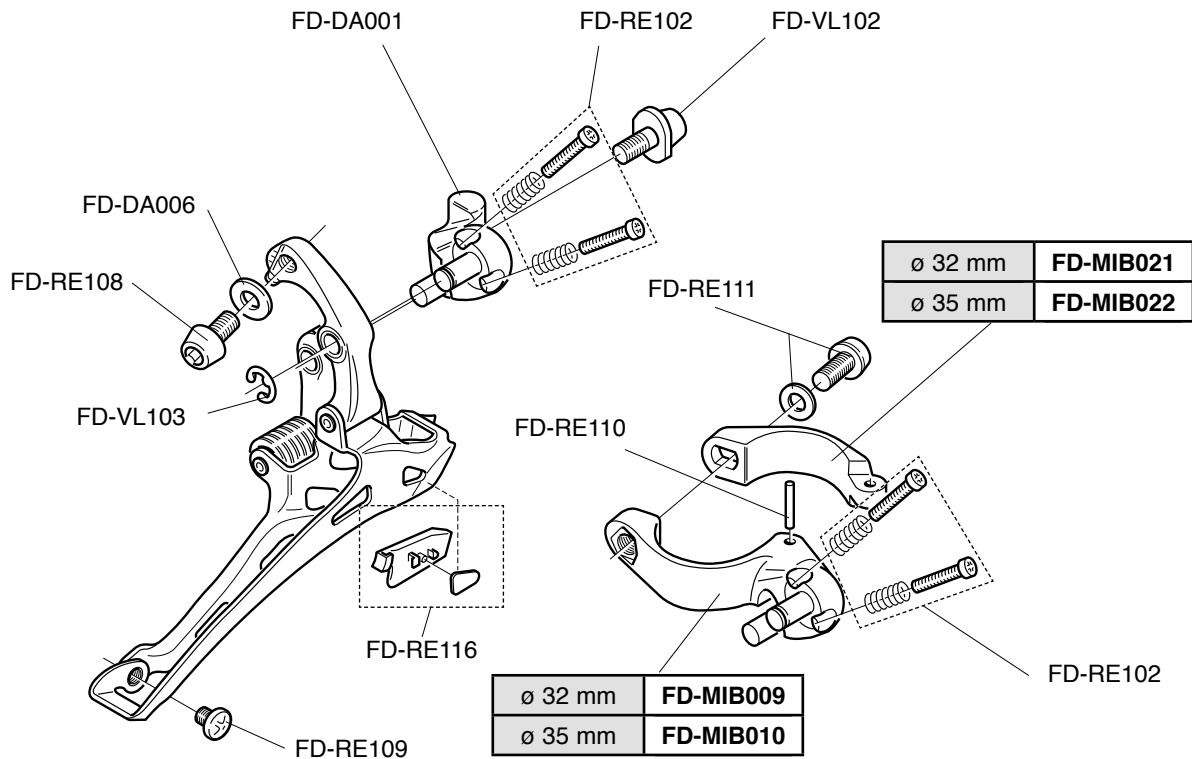

XENON™ QS™
CT™ 10s
FD7-XE2...CT

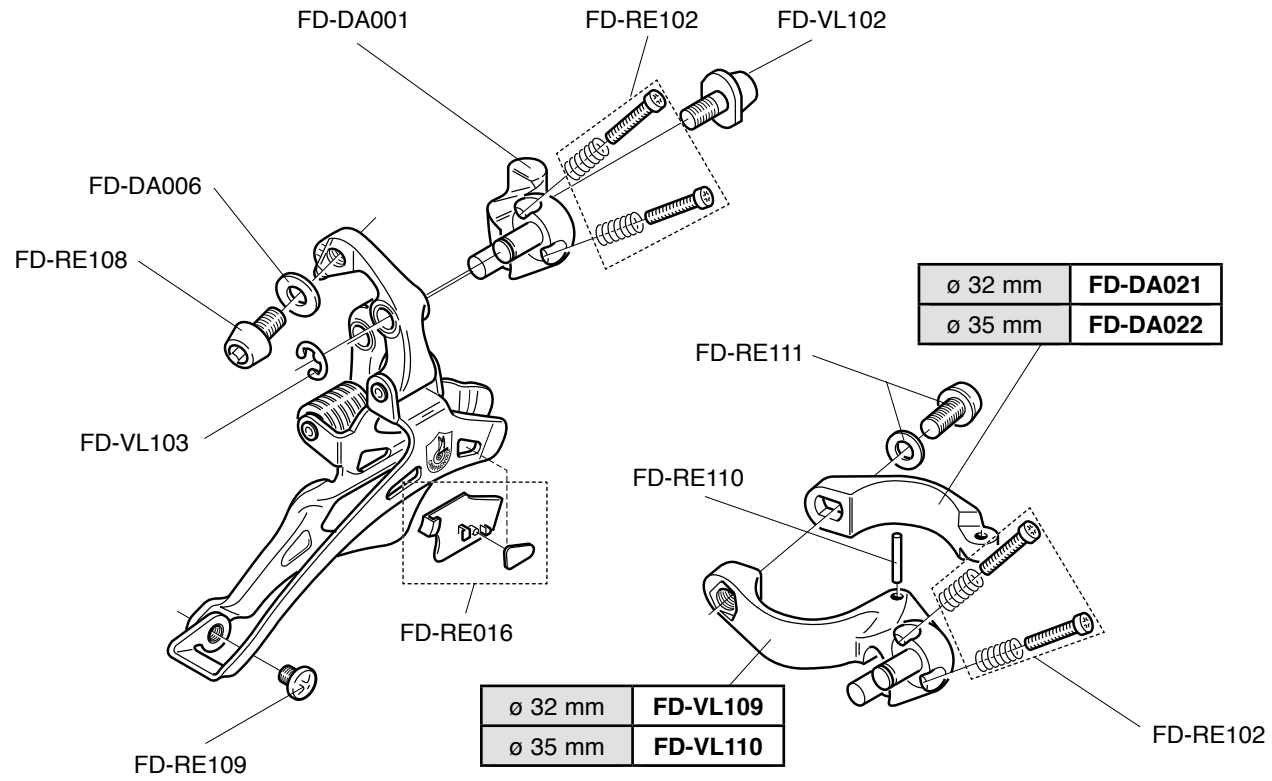

COMP TRIPLE™
10s
FD7-CO3..

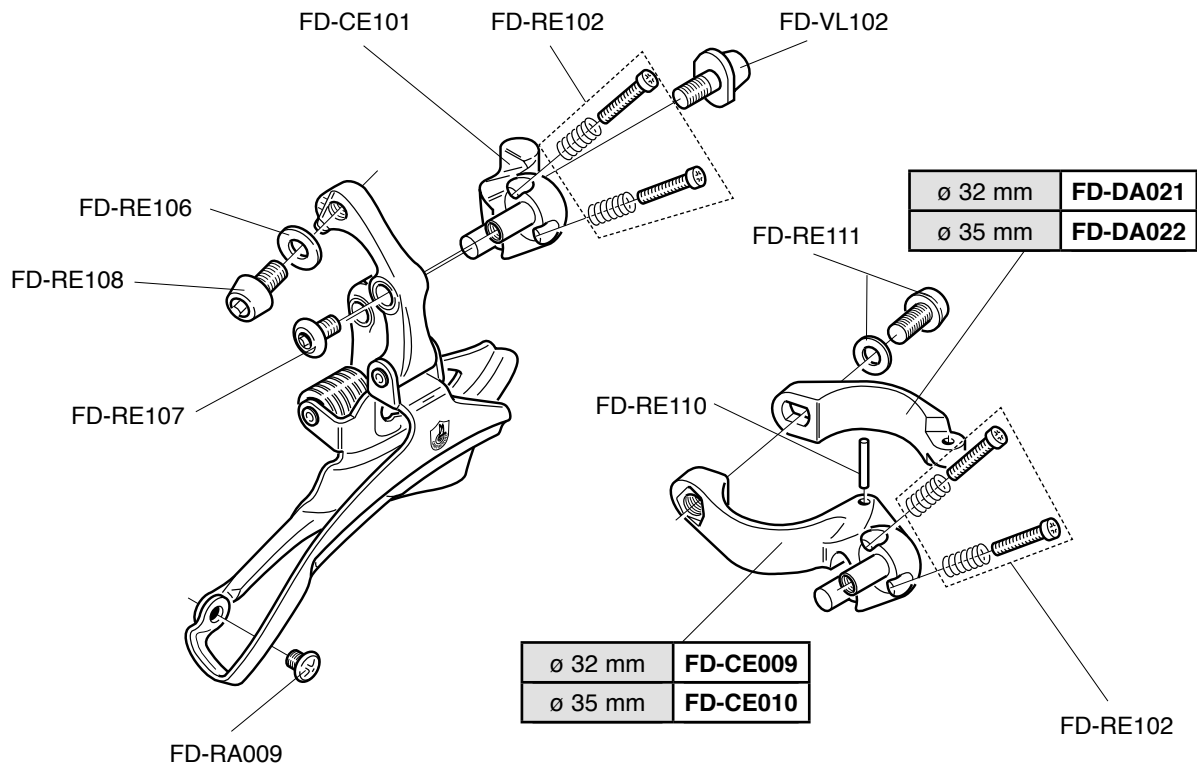

RACE TRIPLE™
10s
FD7-RA3..

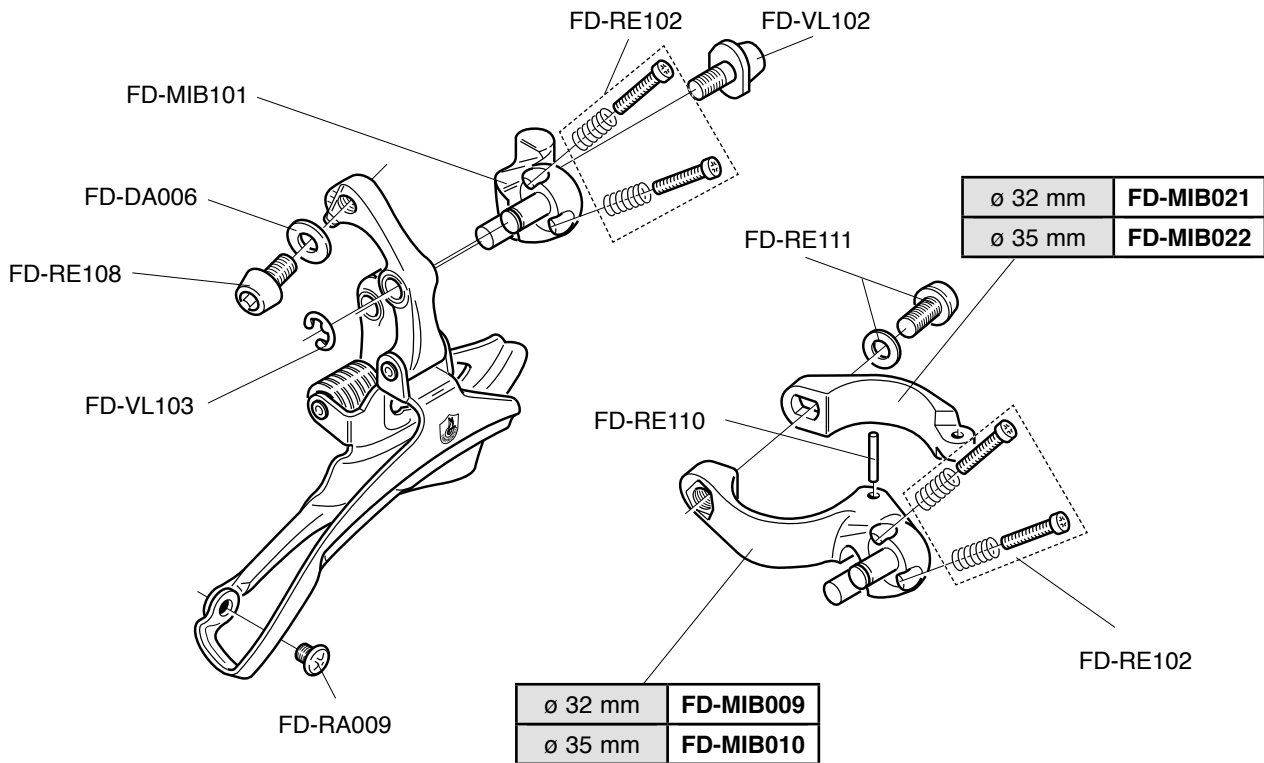

CHAMP TRIPLE™

9s

FD7-CP3..

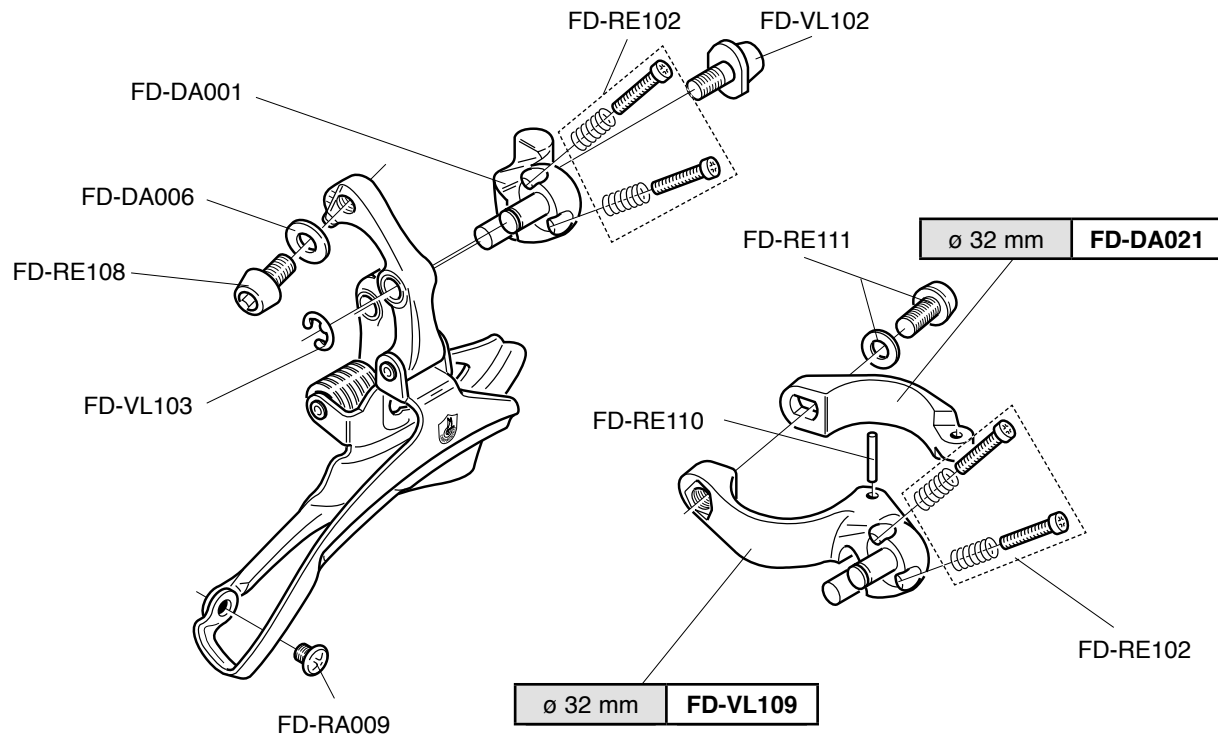

FRONT DERAILLEUR

RECORD™ QS™
10s *
EP7-REXC

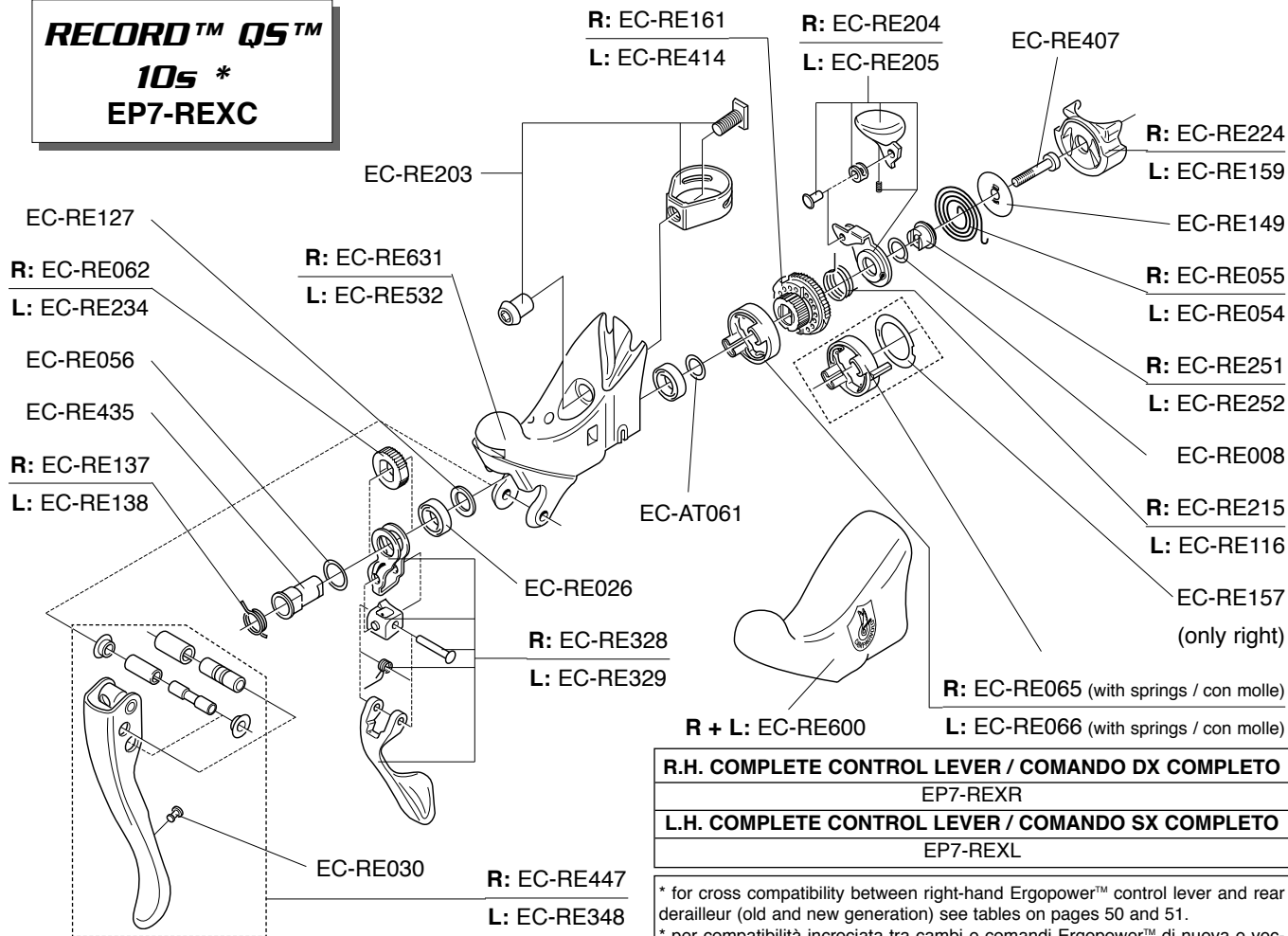

R.H. COMPLETE CONTROL LEVER / COMANDO DX COMPLETO
EP7-REXR
L.H. COMPLETE CONTROL LEVER / COMANDO SX COMPLETO
EP7-REXL

* for cross compatibility between right-hand Ergopower™ control lever and rear derailleur (old and new generation) see tables on pages 50 and 51.
 * per compatibilità incrociata tra cambi e comandi Ergopower™ di nuova e vecchia generazione vedi tabelle alle pagg. 50 e 51.

CHORUS™ QS™
10s *
EP7-CHXC

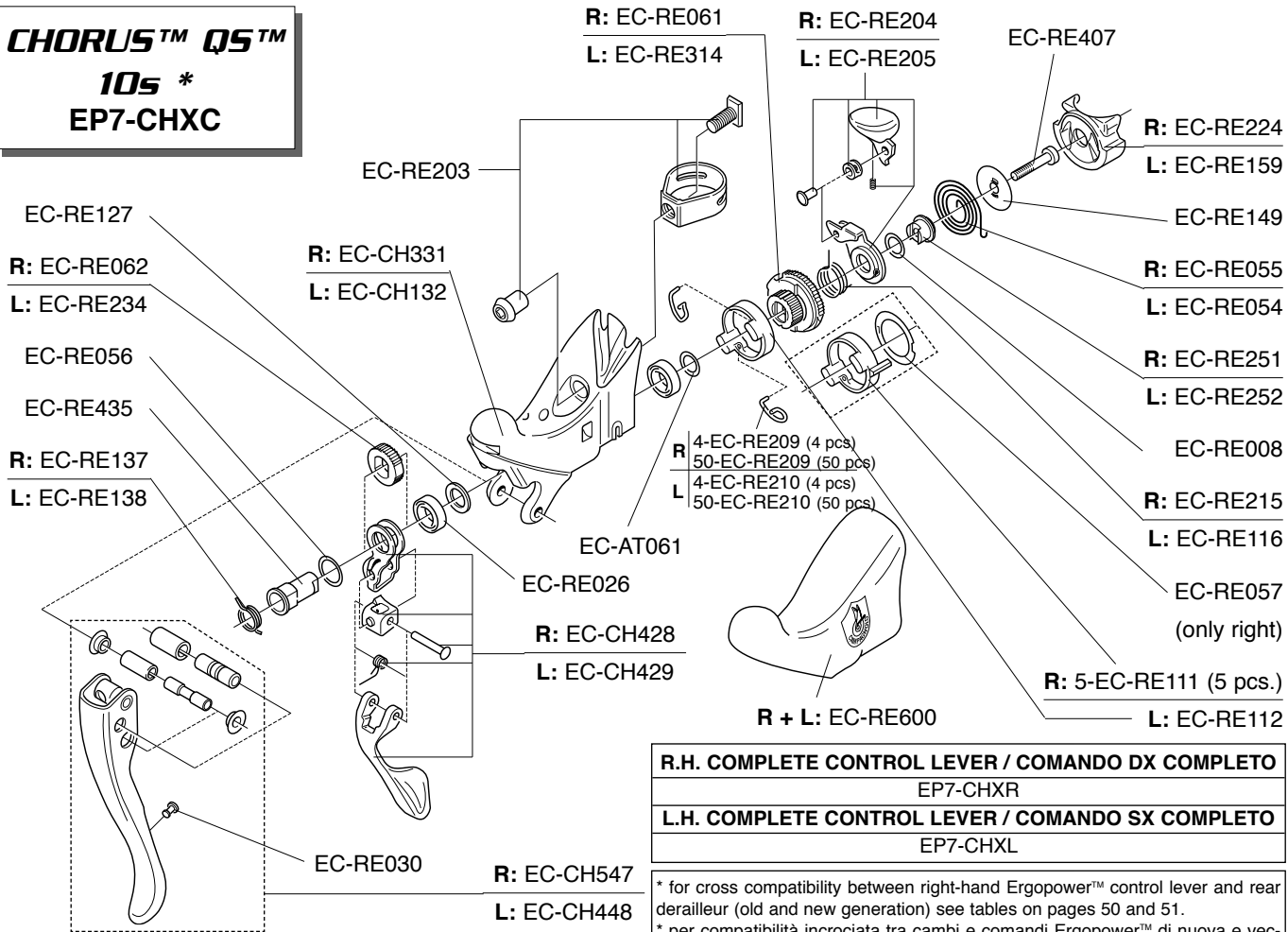

R.H. COMPLETE CONTROL LEVER / COMANDO DX COMPLETO
EP7-CHXR
L.H. COMPLETE CONTROL LEVER / COMANDO SX COMPLETO
EP7-CHXL

* for cross compatibility between right-hand Ergopower™ control lever and rear derailleur (old and new generation) see tables on pages 50 and 51.
 * per compatibilità incrociata tra cambi e comandi Ergopower™ di nuova e vecchia generazione vedi tabelle alle pagg. 50 e 51.

**CENTAUR™ QS™
ESCAPE™ 10s *
EP7-CEXC**

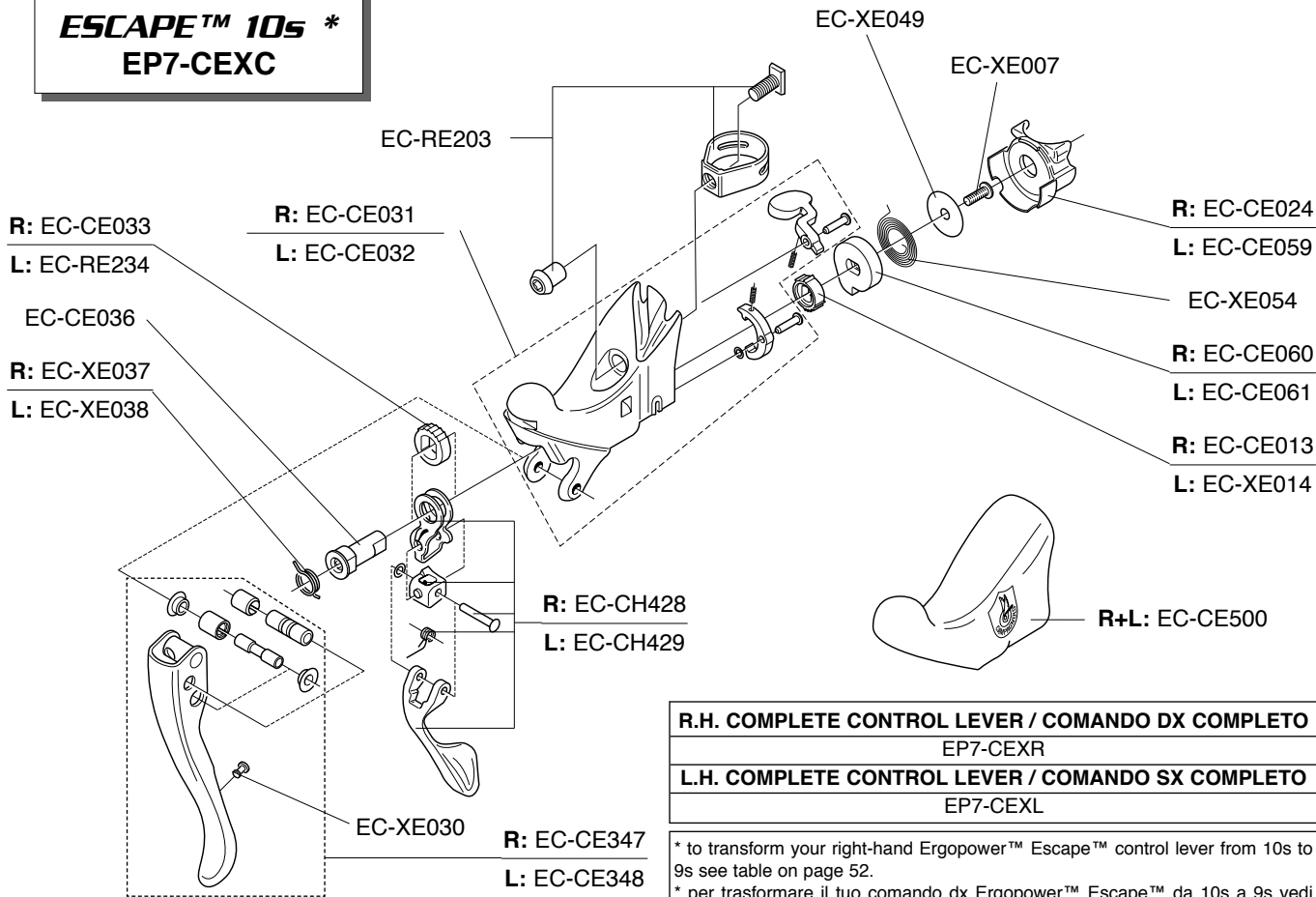

R.H. COMPLETE CONTROL LEVER / COMANDO DX COMPLETO
EP7-CEXR
L.H. COMPLETE CONTROL LEVER / COMANDO SX COMPLETO
EP7-CEXL

* to transform your right-hand Ergopower™ Escape™ control lever from 10s to 9s see table on page 52.
* per trasformare il tuo comando dx Ergopower™ Escape™ da 10s a 9s vedi tabella a pag. 52.

VELOCE™ QS™ ESCAPE™ 10s* EP7-VLXC
VELOCE™ INFINITE™ QS™ ESCAPE™
10s* EP7-VLNXC

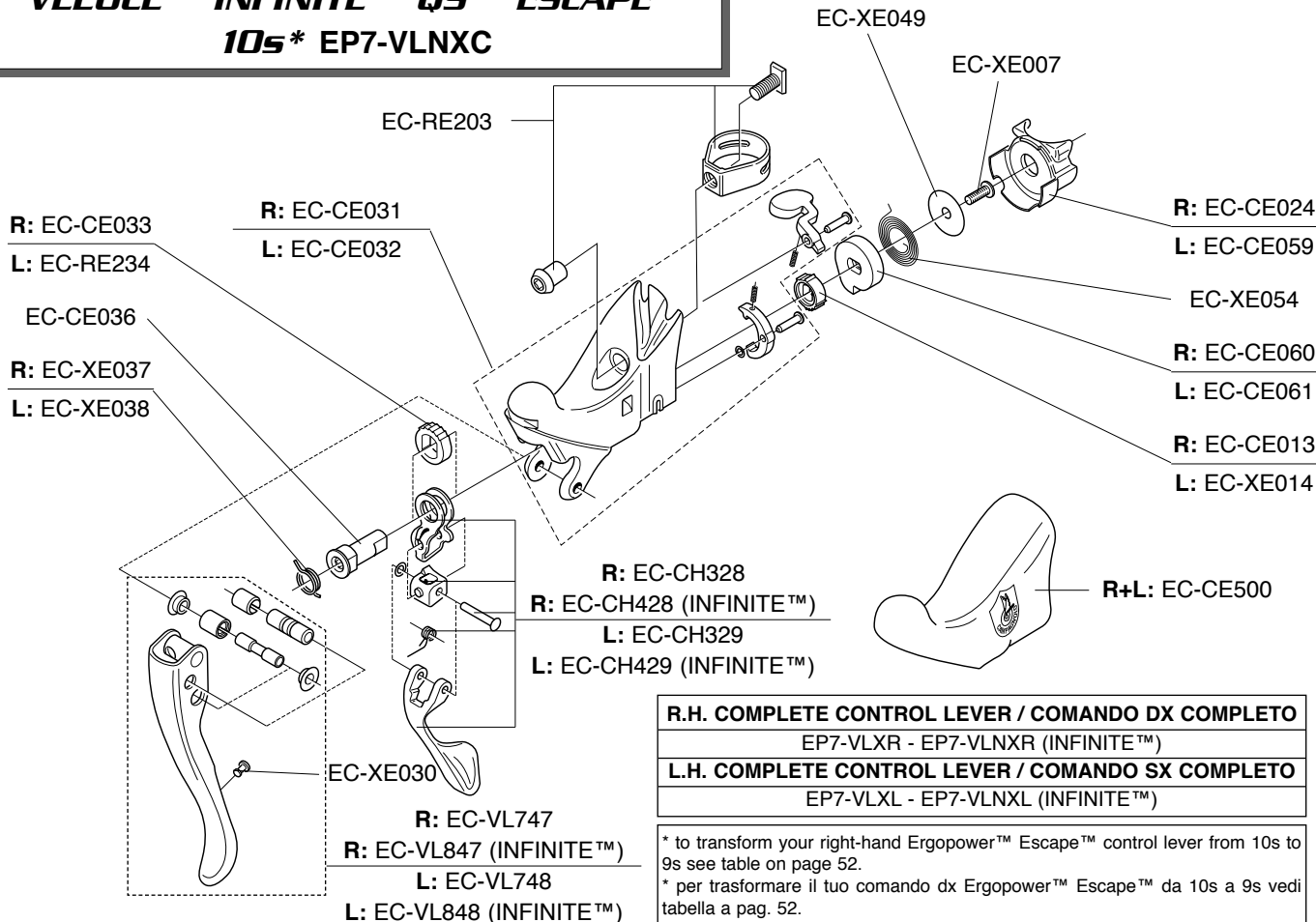

R.H. COMPLETE CONTROL LEVER / COMANDO DX COMPLETO
EP7-VLXR - EP7-VLNXR (INFINITE™)
L.H. COMPLETE CONTROL LEVER / COMANDO SX COMPLETO
EP7-VLXL - EP7-VLNLX (INFINITE™)

* to transform your right-hand ErgoPower™ Escape™ control lever from 10s to 9s see table on page 52.
 * per trasformare il tuo comando dx ErgoPower™ Escape™ da 10s a 9s vedi tabella a pag. 52.

**MIRAGE™ QS™
ESCAPE™ 10s *
EP7-MIXC**

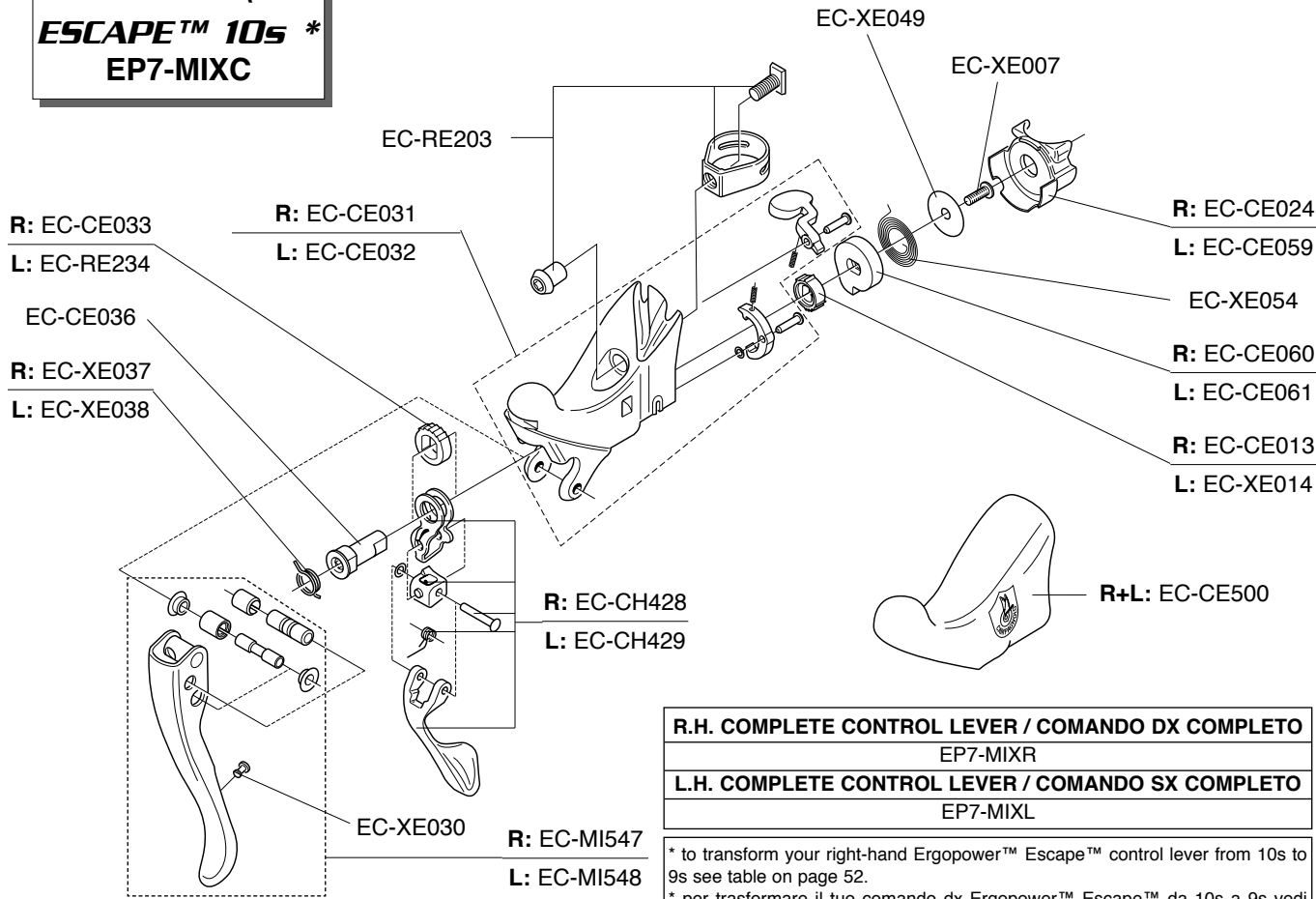

R.H. COMPLETE CONTROL LEVER / COMANDO DX COMPLETO
EP7-MIXR
L.H. COMPLETE CONTROL LEVER / COMANDO SX COMPLETO
EP7-MIXL

* to transform your right-hand ErgoPower™ Escape™ control lever from 10s to 9s see table on page 52.

* per trasformare il tuo comando dx ErgoPower™ Escape™ da 10s a 9s vedi tabella a pag. 52.

XENON™ QS™
ESCAPE™ 10s *
EP7-XEXC

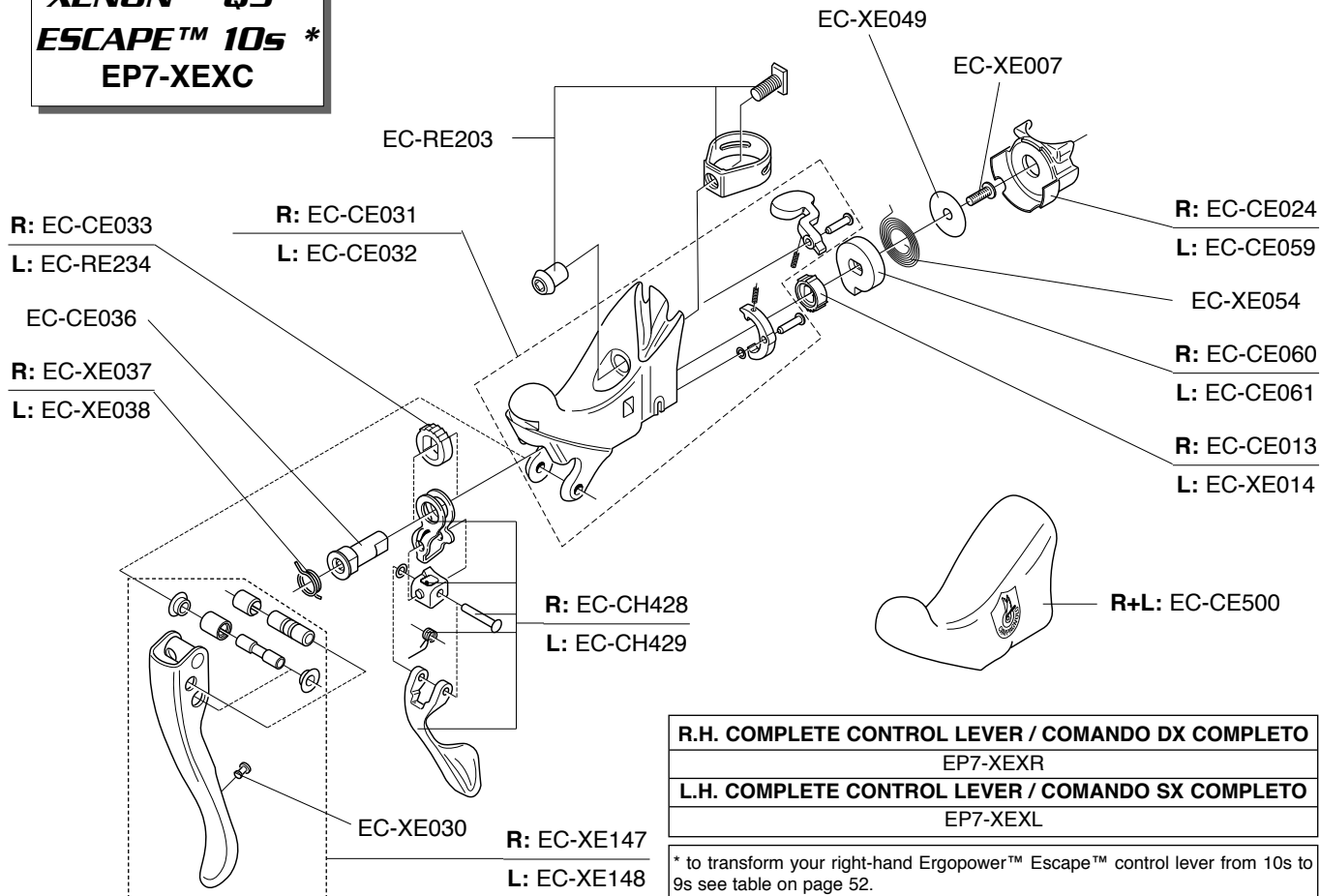

R.H. COMPLETE CONTROL LEVER / COMANDO DX COMPLETO

EP7-XEXR

L.H. COMPLETE CONTROL LEVER / COMANDO SX COMPLETO

EP7-XEXL

* to transform your right-hand ErgoPower™ Escape™ control lever from 10s to 9s see table on page 52.

* per trasformare il tuo comando dx ErgoPower™ Escape™ da 10s a 9s vedi tabella a pag. 52.

**CROSS COMPATIBILITY BETWEEN RIGHT-HAND ERGOPOWER™
CONTROL LEVERS AND REAR DERAILLEURS
(old and new generation)**

**COMPATIBILITÀ INCROCIATA TRA COMANDI ERGOPOWER™ DX E CAMBI
(nuova e vecchia generazione)**

ERGOPOWER™ CONTROL LEVERS / COMANDI ERGOPOWER™

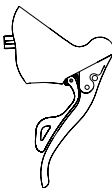
SPEED / VELOCITÀ	YEAR / ANNO	FEATURES / CARATTERISTICHE		
8s	< 1988	"old style" (pointed) body / corpo a punta		up to/ fino al 1997
9s	1997	"old style" (pointed) body / corpo a punta		
9s	1998	"new style" (rounded) body / corpo arrotondato		
9s	1999-2000	"new style" (rounded) body, ErgoBrain computer ready / corpo arrotondato, predisposizione ErgoBrain		from/dal 1998 to/al 2008
9s	2001-2006	"9 speed" mark, "new style" (rounded) body, ErgoBrain™ computer ready / logo "9 speed" sul corpo, corpo arrotondato, compatibile con ErgoBrain™		
10s	2000-2006	"10 speed" mark, "new style" (rounded) body, ErgoBrain10™ computer ready / logo "10 speed" sul corpo, corpo arrotondato, compatibile con ErgoBrain10™		
10s RECORD™/CHORUS™	2007-2008	"new style" body, "QS" mark on the left body, ErgoBrain10™ computer ready / logo "QS" sul corpo comando sinistro, compatibile con ErgoBrain10™		
10s CENTAUR™/VELOCE™/ MIRAGE™/XENON™	2007-2008	"QS" mark on the left body, ESCAPE™ mechanism not compatible with ErgoBrain™ and ErgoBrain10™ computer/ logo "QS" sul corpo comando sinistro, meccanismo ESCAPE™ non compatibile con ErgoBrain™ e ErgoBrain10™		

REAR DERAILLEUR / CAMBIO

SPEED / VELOCITÀ	YEAR / ANNO	FEATURES / CARATTERISTICHE
8s	< 1998	adjusting system on the upper body / sistema di registrazione sul corpo superiore
9s	1997-2000	adjusting system on the upper body / sistema di registrazione sul corpo superiore
9s	2001-2008	adjusting system on the lower body / sistema di registrazione sul corpo inferiore



**CROSS COMPATIBILITY BETWEEN RIGHT-HAND ERGOPOWER™
CONTROL LEVERS AND REAR DERAILLEURS
(old and new generation)**

**COMPATIBILITÀ INCROCIATA TRA COMANDI ERGOPOWER™ DX E CAMBI
(nuova e vecchia generazione)**

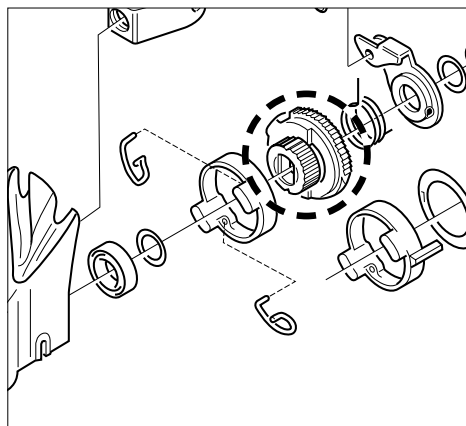

The codes in the table are referring to the indexing ratchet of the right-hand Ergopower™ (see the figure). To ensure the compatibility between replace the indexing ratchet with the one indicated in the table (referring to the rear derailleur / Ergopower™ control levers combination).

I codici in tabella si riferiscono alla bussola dentata (evidenziata in figura) del comando dx Ergopower™: per assicurare la compatibilità tra cambio ed Ergopower destro, va eventualmente sostituita la bussola dentata esistente con quella indicata in tabella (a seconda della combinazione cambio / comandi Ergopower™).

	9s 2001-2008 rear derailleur / cambio 9s 2001-2008	9s 1997-2000 rear derailleur / cambio 9s 1997-2000	8s rear derailleur / cambio 8s
Ergopower™ 8s	OK * (with C9 chain / con catena C9)	OK * (with C9 chain / con catena C9)	OK
Ergopower™ 9s 1999-2000	EC-RE063	OK	EC-RE060
Ergopower™ 9s 2001-2006	OK	EC-RE313	EC-RE060
Ergopower™ 10s 2000-2006	EC-RE063	EC-RE313	EC-RE060
Ergopower™ 10s 07/08 RE-CH	EC-RE063	EC-RE313	EC-RE060

**CROSS COMPATIBILITY BETWEEN RIGHT-HAND ERGOPOWER™ ESCAPE™
CONTROL LEVERS AND REAR DERAILLEURS
(9s/10s)**

**COMPATIBILITÀ INCROCIATA TRA COMANDI ERGOPOWER™ ESCAPE™ DX E CAMBI
(9s/10s)**

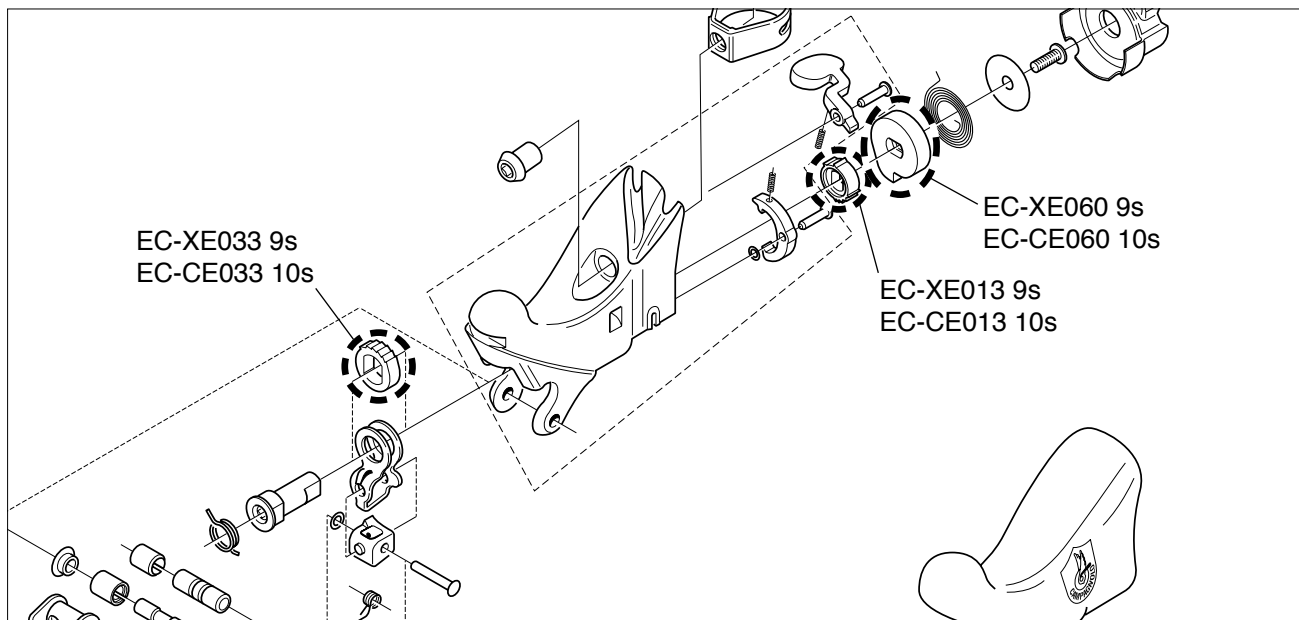

	9s rear derailleur / cambio 9s	10s rear derailleur / cambio 10s
Ergopower™ Escape™ 9s	OK	EC-CE033, EC-CE013, EC-CE060
Ergopower™ Escape™ 10s	EC-XE033, EC-XE013, EC-XE060	OK